

An abstract collage artwork featuring a variety of colors including deep blues, purples, greens, and yellows. The composition is layered with different textures, such as smooth paper, rough-edged paper, and circular patterns. A prominent feature is a large, light-colored, textured area in the center-right, resembling a flower or a large brushstroke. The overall effect is dynamic and rhythmic.

Rhythm & A GCA Major Flower Show *Hues*

April 12-14, 2024
Dixon Gallery & Gardens
Memphis, TN



Memphis Garden Club,
a Member of The Garden Club of America,
and Dixon Gallery and Gardens

present

THE MEMPHIS FLOWER SHOW

Rhythm & A GCA Major Flower Show *Hues*

APRIL 12-14, 2024

OPEN TO THE PUBLIC

Saturday, April 13, 9:00 a.m. - 6:00 p.m.

Sunday, April 14, 11:00 a.m. - 5:00 p.m.

Dixon Gallery and Gardens
4339 Park Avenue
Memphis, Tennessee 38117

OPEN TO THE PUBLIC | FREE OF CHARGE

Thanks to the generosity of the Crawford-Howard Private Foundation

OPPOSITE PAGE: KONG WEE PANG | *Rain*, 2023 | Watercolor | on unprimed canvas | 40 x 50 inches
Courtesy of the artist



PAM MCDONNELL
Self-Portrait, 2022 | Oil on Linen | 48 x 48 inches | Courtesy of the artist

Welcome to Memphis, a magical place set high atop a once-wooded bluff overlooking the mighty Mississippi River. It is a place where the confluence of past and present, culture and community, join together to generate the very heartbeat that drives its creative soul.

“Rhythm and Hues,” celebrates the beauty of nature and art through the rhythm and the hues that paint our world with color. Immerse yourself in the sights, sounds, and scents of the Dixon Gallery and Gardens. Be enchanted by the beauty of nature and art brought to life through the exquisite artistry of Floral Design, Horticulture, Botanical Arts, Photography, and Conservation.

With history as its canvas and the river as its muse...
Memphis is a city of Rhythm and Hues.

Kaki and Kathryn

The purpose of The Garden Club of America is to stimulate the knowledge and love of gardening, to share the advantages of association by means of educational meetings, conferences, correspondence and publications, and to restore, improve and protect the quality of the environment through educational programs and action in the fields of conservation and civic improvement.

The purpose of a flower show is threefold: to set standards of artistic and horticultural excellence; to broaden knowledge of horticulture, floral design, conservation, photography and other related areas; and to share the beauty of a show with fellow club members and with the public.

The Garden Club of America *Flower Show and Judging Guide*,
July 2022 Edition

EMYO
Gathered 2, 2023 | Mixed Media | 36 x 36 inches | Courtesy of the artist

Timetable for Exhibitors | 1

Lecture Series | 9

Memphis Flower Show Committee | 11

GCA General Rules and General Information | 17

Museum Rules | 21

Museum Staff | 22

Division I: Floral Design

Floral Design Guidelines | 24

Floral Design Classes | 28

Division II-A: Horticulture

Horticulture Guidelines | 39

Horticulture Classes | 44

Division II-B: Horticulture Design

Horticulture Design Guidelines | 54

Horticulture Design Classes | 57

Division III: Photography

Photography Guidelines | 59

Photography Classes | 64

Division IV: Botanical Arts

Botanical Arts Guidelines | 66

Botanical Arts Classes | 69

Division V: Education

Statement of Intent | 70

GCA Flower Show Awards | 71

Memphis Garden Club Awards | 74

Notes | 75

Maps | 77



KELLY COOK HARMON
Amber and Ruth, 2023 | Watercolor on wood | 30 x 42 inches | Courtesy of the artist

- MONDAY, APRIL 10, 2023** **Horticulture** one-year ownership deadline
- MONDAY, SEPTEMBER 11, 2023** Online registration opens for **Floral Design, Horticulture Design,** and **Botanical Arts** to members of all GCA clubs
- SUNDAY, OCTOBER 1, 2023** Online registration opens for **Photography**
- TUESDAY, OCTOBER 10, 2023** **Horticulture** six-month ownership deadline

- WEDNESDAY, JANUARY 10, 2024** **Horticulture** three-month ownership deadline
Photography deadline to receive images
- THURSDAY, FEBRUARY 8, 2024** Juried **Photography** finalists notified
- MONDAY, FEBRUARY 12, 2024** **Floral Design** registration deadline
Horticulture Design registration deadline
Botanical Arts registration deadline
- MONDAY, MARCH 11, 2024** **Floral Design** Statement of Intent and list of plant material deadline
Horticulture Design Statement of Intent and list of plant material deadline
Floral Design Judges' Challenge Class entry fee due
Photography delivery deadline for mounted photographs
- TUESDAY, MARCH 12, 2024** Final passing date for **Photography**
- FRIDAY, MARCH 15, 2024** **Botanical Arts** delivery deadline, if mailed. All Botanical Arts entries will be reviewed upon receipt and exhibitors will be notified of any damage during shipping.

Horticulture | Floral Design | Horticulture Design | Botanical Arts Education | Photography

WEDNESDAY, APRIL 10, 2024

- 11:30 a.m. **Horticulture Passing Judges**
Horticulture Passing Judges arrive at the Dixon
- 12:00 p.m. – 4:00 p.m. Horticulture Passing for Division II-A, container grown plants and collections and Horticulture Design II- B entries Horticulture Exhibitors
- 12:00 p.m. – 4:00 p.m. Horticulture container-grown plants and collections received and passed Horticulture Design Exhibitors
- 12:00 p.m. – 4:00 p.m. Horticulture Design entries received and passed Conservation/Education Division V
- 12:00 pm.- 4:00 p.m. **Horticulture Passing Judges** pass Division V exhibit
- 4:15 p.m. **Horticulture Passing Judges** depart for DoubleTree
- 6:15 p.m. Cars depart for Early Arrival Dinner
- 6:30 p.m. Early Arrival Dinner
Veazey Krausnick’s Home
152 Lombardy Memphis, TN 38111
Purchase ticket at
www.mephisgardenclub.org

THURSDAY, APRIL 11, 2024

- 8:30 a.m. **Horticulture Passing Judges**
Horticulture Passing Judges leave the DoubleTree for the Dixon
- 9:00 a.m. – 4:00 p.m. **Horticulture Passing Judges** pass cut entries for Division II-A only
- 4:15 p.m. Buses leave the Dixon for the DoubleTree
- 9:00 a.m. – 12:00 p.m. **Botanical Arts Exhibitors**
Hand-delivered entries delivered to the Living Room at the Dixon for passing
- 12:00 p.m. – 4:00 p.m. **Floral Design Exhibitors**
Division I exhibitors, except Challenge Class exhibitors, may preview the site, create and complete entries on site
- 12:00 p.m. – 4:00 p.m. **Floral Design Passing Judges**
Two panels will be available
- 6:00 p.m. **Judges**
Buses depart the DoubleTree for the Judges’ Dinner
- 6:30 p.m. Judges’ Dinner
The Memphis Country Club
600 Goodwyn, Memphis, TN 38111
Purchase ticket at
www.memphisgardenclub.org

FRIDAY, APRIL 12, 2024

6:45 a.m.	Judges Passing Judges leave the DoubleTree for the Dixon
7:00 a.m.	Arrival at the Dixon
7:00 a.m. – 8:00 a.m.	Horticulture Passing Judges pass Division II-A for out-of-town judges' entries only
8:45 a.m.	Buses leave the DoubleTree with remaining Judges
9:30 a.m.	Charging of all Judges and Prospectives (Location TBA). Charging of all Candidates and Clerks (Location TBA)
10:00 a.m. – 12:00 p.m.	Judging for all divisions / Special GCA and MGC award judging to follow
12:30 p.m.	Judges', Prospectives', and Candidates' Luncheon and Evaluation, in the Hughes Pavilion
3:00 p.m.	Buses leave the Dixon for the DoubleTree
6:45 a.m.	Floral Design Exhibitors Buses leave the DoubleTree for the Dixon
7:00 a.m.	Arrival at the Dixon
7:00 a.m.	Dixon Gallery and Gardens doors open
7:00 a.m. – 9:15 a.m.	Passing continues from previous day All exhibitors creating and arranging on site Judges' Challenge Class creating and arranging on site
9:15 a.m.	All Floral Design passing closes

6:45 p.m.

Judges and Exhibitors

Buses depart the DoubleTree for the Preview Party

7:00 p.m. - 9:00 p.m.

Preview Party
Purchase ticket at www.memphisgardenclub.org

9:15 p.m.

Buses leave the Dixon for the DoubleTree

SATURDAY, APRIL 13, 2024

8:00 a.m. – 9:00 a.m.

Dixon is open for maintenance of entries to remain in show condition. Transportation is available from the DoubleTree to the Dixon upon request to the Transportation Committee

9:00 a.m. – 6:00 p.m.

Memphis Flower Show and Vendor Tents open to the public

10:00 a.m.

Morning lecture: Bryan Huffman and Thomas Lloyd in the Hughes Pavilion
Purchase tickets at www.memphisgardenclub.org

2:00 p.m.

Afternoon lecture: Mark D. Sikes in the Hughes Pavilion
Purchase tickets at www.memphisgardenclub.org



CARL E. MOORE
Girl with Water Flowers, Part 2, 2023 | Acrylic on canvas | 48 x 48 inches
 Courtesy of the artist

SUNDAY, APRIL 14, 2024

Results of photography judging emailed

- 9:00 a.m. – 11:00 a.m. Dixon open for maintenance of entries to remain in show condition
- 11:00 a.m. – 5:00 p.m. Memphis Flower Show open to the public
- 5:15 p.m. – 6:00 p.m. Removal of all exhibits strongly suggested, including Horticulture entries

MONDAY, APRIL 15, 2024

- 9:00 a.m. – 12:00 p.m. Deadline for removal of all exhibits
 Removal of entries will take place on Sunday, April 15 from 5:15 p.m. to 6:00 p.m. and on

All items left after 12:00 p.m. on Monday will be discarded unless arrangements have been made with the Container Return Chairs. Remaining flowers will be arranged and delivered to Memphis Garden Club Life Members and Memphis retirement communities.

SATURDAY, APRIL 13, 2024 | 10:00 AM | HUGHES PAVILION

Bryan Huffman



Bryan Huffman is a residential interior designer who was a close friend of Mrs. Mellon for many years. Along with her grandson, Thomas Lloyd, he has co-authored three books relating to Mrs. Mellon's aesthetic: *Bunny Mellon Style*, *Garden Secrets of Bunny Mellon*, and *Bunny Mellon Garden Journal*.

Thomas Lloyd



Thomas Lloyd is President of the Gerard B. Lambert Foundation, founded by his grandmother, Bunny Mellon. He is a Certified Financial Planner® who specializes in developing individual financial plans for high-net-worth individuals and institutions. He currently serves on the boards of The Trustees Council of the National Gallery of Art, The Institute of Classical Art & Architecture, and the PEN/Faulkner Foundation. Lloyd lives in Washington, D.C. with his two children Teddy and Fiona.

SATURDAY, APRIL 13, 2024 | 2:00 PM | HUGHES PAVILION

Mark D. Sikes



Mark D. Sikes is an esteemed interior designer and tastemaker working on projects throughout the United States and abroad, including the White House and Blair House. He is known for all-American sensibilities and a fresh take on classical aesthetics. Mark has a talent for creating beautiful and timeless interiors that embody an indoor/outdoor lifestyle.

His rooms have been much celebrated, and his work has been featured in numerous design magazines and show houses. Mark is a current member of the AD100 list and *Elle Decor's* A-List for both 2021 and 2022. Mark has several ongoing product collaborations including décor with Anthropologie, fabric with Schumacher, furniture with Chaddock, and lighting with Hudson Valley Lighting.

He is excited to announce upcoming collaborations with Samuel & Sons, Perennials, Chesney's, and Modern Matter. Mark's first book, *Beautiful*, was a *New York Times* bestseller and was followed up by *More Beautiful*, which debuted in 2020. Mark is currently working on his third book with Rizzoli featuring interiors throughout the country. His highly anticipated fourth book with Rizzoli will chronicle the process of building his new home, Orange Hill Farm, in Ojai, California, a personal project that will become the backdrop for his brand and firm.

Mark seeks to create beautiful interiors and, above all, a more beautiful world. Beauty is everywhere. It surrounds us each and every day; all we have to do is look.

Chairs	Kathryn Painter Kaki Smith	kathryn.painter@yahoo.com kakivs@bellsouth.net
Club President	Pam Martin	pammartin2020@gmail.com
Treasurer	Llewellyn Hall	llew@mcvean.com

Division I: FLORAL DESIGN

Chair	Cary Brown	carycbrown@gmail.com
Vice Chairs	Elizabeth Coors Edie Marshall Julie Spear	ehcoors@comcast.net edithhm@icloud.com juliewspear@gmail.com
Floral Design Consultant	Emily McEwan	bmcewan1@comcast.net
Registration	Catherine Stallings Katie Dickinson	ccstallings@bellsouth.net kdickinson351@gmail.com
Challenge Class Chairs	Ruthie Bowlin Russell Whitehead Palmer Smith	ruthbowlin@aol.com russellwhitehead@yahoo.com palmersmith@gmail.com
Container Return	Nancy Morrow Gwen Owen Edwina Johnson	morrownancyj@gmail.com gwenpowen@yahoo.com ejohnson63@bellsouth.net
Dixon Liaison	Julie Pierotti	jpierotti@dixon.org
Floral Maintenance	Margaret Ledbetter Wilda Hudson	moledbetter@mac.com woowoo@live.com
Schedule	Pam Martin Kathryn Painter Kaki Smith Adele Wellford	pammartin2020@gmail.com kathryn.painter@yahoo.com kakivs@bellsouth.net adelewellford@mac.com

Division II-A: HORTICULTURE

Chair	Gwin Erb	gwnerb@yahoo.com
Co-Chairs	Caroline Orr Elizabeth Dickinson	carolineorr@me.com edickinson007@comcast.net
Challenge Class Chairs	Tay Chafin Margaret Atkinson	taychafin@me.com margaret.erb.atkinson@gmail.com
Horticulture Consultant	Roberta Anderson	rtasnow@gmail.com
Grooming & Receiving Chair	Roberta Anderson	rtasnow@gmail.com
Identification Chair	Debbie Pittman	deborahpittman@live.com
Identification Chair	Frances Montgomery	fvmontgomery@aol.com
Registration/Entry	Elise Crockett May Weiss	elisecrockett@comcast.net maymayweiss@icloud.com
Rejuvenation	Amy Drennon	aadrennon@icloud.com
Schedule	Caroline Orr Gwin Erb	carolineorr@me.com gwnerb@yahoo.com
Placement	Suzanne Plyler	suzieplyler@att.net
Placement Co-Chairs	Melanie McFadden Stephanie Hayes	goathillfarmtn@gmail.com stephaniefhayes@me.com

Division II-B: HORTICULTURE DESIGN

Co-Chairs	Caroline Orr Elizabeth Dickinson	carolineorr@me.com edickinson007@comcast.net
------------------	-------------------------------------	---



BEN BUTLER
Organelle 1, (Detail) 2023 | Red grandiswood | 36 x 48 inches | Courtesy of the artist

Division III: PHOTOGRAPHY

Co-Chairs Irene Brownlow irenebrownlow2@gmail.com
 Lindsay Lewis lindsayhewis@yahoo.com

Photography Consultant Lysbeth Francis ldkfrancis@aol.com

Committee Elizabeth Dickinson edickinson007@comcast.net
 Rose Garrett rosejgarrett@gmail.com
 Maryan Mercer maryanmercergmail.com
 Edie Robinson ediemrt@aol.com
 Ferrin Mavar ferrintmavar@gmail.com
 Adele Wellford adelewellford@mac.com

Division IV: BOTANICAL ARTS

Co-Chairs Ainslie Todd ainslietodd@bellsouth.net
 Elizabeth Coors ehcoors@comcast.net

Division V: EDUCATION

Chair Heather Grosvenor heather1henry1@gmail.com

Committee Stephanie Linkous srlinkous@gmail.com
 Miriam Smith miriamasmith@gmail.com

Education Consultant Elizabeth Coors ehcoors@comcast.net

OTHER COMMITTEES

Awards Chair Laine Park lep950@aol.com

Co-Chair Debbie Havner dahavner@me.com

Calligraphy Chair Lisa Colcolough lisa.colcolough@gmail.com

OTHER COMMITTEES

Committee	Beth Buchignani Elizabeth Glassell	beth.buchignani@gmail.com eglassell@aol.com
Container Return Chairs	Nancy Morrow Gwen Owen	morrownancyj@gmail.com gwenpowen@yahoo.com
Data Entry Chair	Terre Sullivant	tsullivant@bellsouth.net
Committee	Irene Ayotte Katie Dickinson	iaotte@comcast.net kdickinson351@gmail.com
Fundraising Chairs	Buff Adams Lysbeth Francis	mredbirds@gmail.com ldkfrancis@aol.com
Hospitality Chair	Carol Stout	carolstout56@gmail.com
Committee	Ann Boyd Janie Hopkins Barbara Prest Kathy Shannon Miriam Smith	hallamjr@comcast.net janie.hopkins@crye-leike.com boowho10@bellsouth.net kathy.shannon.maury@gmail.com miriamasmith@gmail.com
Hotel Liaison	Cile Collier	ccollier3027@gmail.com
Judges Chair	Barton Lynch	bartonslynch@gmail.com
Luncheon Chair	Lida Bross	lida.bross@gmail.com
Committee	Buff Adams Lida Bross Brandon Morrison Julie Spear	mredbirds@gmail.com lida.bross@gmail.com brandongmorrison@aol.com juliewspear@gmail.com
Judges' Dinner Co-Chairs	Lysbeth Francis Frances Montgomery Elizabeth Coors	ldkfrancis@aol.com fvmontgomery@aol.com ehcoors@comcast.net

Name Badges Chair

Selden Popwell sepopwell@aol.com

Preview Party Co-Chairs

Nancy Miller nancymiller@me.com
Muffy Turley muffyturley@me.com

Public Relations Chair

Jenne Williams jennewilliams@comcast.net

Show Photographer

Whitney McNeill webgrove@bellsouth.net

Signage Chair

Stephanie Linkous srlinkous@gmail.com

Speaker Co-Chairs

Kaylea Hill kayleahill@gmail.com
Allison Braswell albras@me.com

Staging Co-Chairs

Kelly Burrow ksburrow1@hotmail.com
Anne Keeney aokeeney6070@gmail.com

Transportation Co-Chairs

Tina Todd tinamtodd@comcast.net
Jeanne Wilbourn jwilbour@icloud.com

Vendor Marketplace Co-Chairs

Emily McEwan bmcewan1@comcast.net
Veazey Krausnick vk2875@gmail.com

Website Chair

Katie Dickinson kdickinson351@gmail.com

Weekend Hostess Chair

Emily Lowrance elowrance5@gmail.com

GCA Rules & General Information

1. Please carefully read and follow GCA Flower Show Rules, General Information and Division Guidelines. All rules as stated in the *Garden Club of America Flower Show and Judging Guide*, July 2022 Edition, shall apply.

All designs must be the original work of the designer(s). Although techniques and components may be inspired by other designs, the application of the techniques and components must create an original design that is distinct from the inspiration.

SAFETY

2. While The Garden Club of America and The Memphis Garden Club will exercise due caution in safeguarding exhibits, responsibility for damage, loss or personal injury cannot be assumed.
3. Entrance to the Dixon Gallery and Gardens will be limited during staging and entry times. Name badges will be required for entrance and time limits will be strictly enforced.

ENTRIES AND PASSING PROCESS

4. Any clarification or change in the rules, as originally stated in the schedule, shall be communicated promptly in writing by the Division Chairs to all exhibitors in the Class and, at the show, to the judges and to the passing committees.
5. Registration is required for all Classes with the exception of those in Horticulture II-A. **Registration forms are available at www.memphisgardenclub.org.** Classes will be filled in the order registration forms are received according to the online date and time stamp. (See specific guidelines for Division I: Floral Design on page 24)
6. Entries are open to all GCA club members, including provisionals, and professionals in their disciplines, except as noted in the schedule. Floral Design Class 10 has specific registration restrictions. Floral Design Class 8 is open only to out of town judges.
7. Entering in a show constitutes permission to use images of the submitted content in all GCA channels of communication.

8. A statement of intent must be submitted at the time of passing. The statement must be no more than 25 words typed or printed in pencil and on a 4 x 6 white lined card. It is required for all Classes, except those in Horticulture II-A. (See specific guidelines for Division I: Floral Design on page 24)
9. An entry card must accompany each entry. Entry cards are available for download at www.memphisgardenclub.org and will be available at the show. Information required on the entry card must be completed in black waterproof medium. Entry cards downloaded from www.memphisgardenclub.org should be printed on white cardstock.
10. The passing committee must pass each entry before the exhibitor(s) may leave the show area. The passing committee reserves the right to refuse any entry that does not conform to the rules of the schedule. The exhibitor has the option of correcting the entry if time permits. If not corrected, the entry cannot be judged but may remain in place, marked "For Exhibit Only" with a brief, constructively worded statement explaining why it was not judged. The judges may not disqualify any entry passed by the passing committee unless evidence of insect infestation or disease is identified.
11. Once an entry is passed, the exhibitor(s) must immediately leave the show floor. The only exception will be flower show committee members who have entered and been passed according to the timetable. A passed entry may not be touched again by the exhibitor until after judging and then only to carry out necessary maintenance.
12. At no time may exhibitors touch any exhibits other than their own.
13. All containers and accessories must be inconspicuously labeled with the exhibitor's name(s).

PLANT MATERIAL

14. All plant material must be correctly identified with the botanical and common names. Accepted references for nomenclature are:
- www.missouribotanicalgarden.org/plantfinder
 - www.rhs.org.uk/plants/search-form
15. The Garden Club of America expects all exhibitors to be aware of the need to promote conservation of endangered and threatened plants. Plants collected in the wild and listed by the Tennessee Natural Heritage Program may not be exhibited in any flower show sponsored by a GCA club. Cultivated plant material listed by Tennessee's Natural Heritage Program may be exhibited if accompanied by a typed card stating that it has not been collected from the wild or that it was collected out-of-state and giving information concerning its cultural requirements and methods of propagation.

Natural Heritage Program lists of endangered plant material will be available before and during the show from the Division Chairs and are available online at <http://plants.usda.gov/threat/html>

16. Plant material showing evidence of insects or disease must be removed immediately from the exhibition area. This rule will be enforced at any time during the show, whenever the problem is identified.
17. Fresh plant material must be in water or conditioned in such a way as to remain in pristine form while on exhibition. An entry not maintained in show condition may have its award removed.
18. Locally invasive plants, diseased plant material, artificial plant material, live animals (including fish), taxidermy, natural birds' nests, feathers of any kind, and protected sea life, including coral, are not permitted. No animal parts (from live or deceased animals) may be used. This includes, but is not limited to, hooves, horns, fur (with the exception of wool/yarn), hair, fins, seashells, and other shells (turtle, egg, etc.). The Photography Division is exempt from this rule, but all photographs must show respect for the natural world and be taken in an ethically responsible way. **Information is available online at <https://plants.usda.gov/home/noxiousInvasiveSearch>**

JUDGING

19. Only participating judges and clerks will be allowed on the show floor during judging. Flower Show Chairs and Division Chairs should remain nearby but off the show floor until needed.
20. A novice is an individual exhibitor who has not won a first place ribbon or a GCA Special Award in the division entered at a GCA Major Flower Show or a Sanctioned Non-GCA Major Flower Show. An exhibitor winning a first-place ribbon in a GCA Flower Show is still considered a novice in a GCA Major Flower Show or a Sanctioned Non-GCA Major Flower Show or in another division of any flower show. In addition, an exhibitor who has won a first place ribbon or Special Award in a GCA Major Flower Show or Sanctioned Non-GCA Major Flower Show is no longer a novice in any level of GCA Flower Shows in the division won. Only individual novice exhibitors are eligible to receive the Sandra Baylor Novice Floral Design Award or the GCA Novice Award. A novice exhibitor will be identified on the entry card, following the initial judging.
21. All Judges' decisions are final.

REMOVAL

22. All exhibits must remain in place and in show condition until fifteen minutes after the closing time of the show.
23. Removal of entries will take place on Sunday, April 14 from 5:15 p.m. to 6:00 p.m. and on Monday, April 15 from 9:00 a.m. to 12:00 p.m. All items left after 12:00 p.m. on Monday will be discarded unless arrangements have been made with the Container Return Chairs. Remaining flowers will be arranged and delivered to Memphis Garden Club Life Members and Memphis retirement communities.

1. Exhibitors should exercise extreme caution while working in the presence of irreplaceable works of art. Use of spray paint, paint and aerosols is not permitted inside the museum. Any use of glitter is prohibited.
2. Remember to look but not touch the artwork. Stay an arm's-length away.
3. Running is not permitted in the galleries.
4. Sketching is limited to pencils. Pens and markers are not permitted.
5. Food, drinks and chewing gum are not allowed in the galleries.
6. Backpacks and umbrellas are not allowed in the galleries and should be stored in the proper area upon arrival.
7. The Museum is not responsible for lost items.
8. Floral Design containers and buckets with minimal water will be permitted during installation.
9. Floral designs may not be misted or spritzed.
10. Cell phone use in the galleries should be kept to a minimum and operated in a manner that is not disturbing to other guests.
11. Flash photography is not permitted in the galleries. Only the official Dixon photographer may use flash cameras.
12. Be quiet and respectful of other visitors in the Museum.
13. Materials and supplies should not lean up against the walls of the galleries or lie on platforms where artwork is displayed. There should be at least 24" between exhibitors' supplies and artwork.
14. Pedestals are not to be moved or adjusted.
15. No outside boxwood is permitted in Dixon Gallery and Gardens because Dixon is a Boxwood Trial Garden. Outside boxwood could possibly introduce the very contagious Boxwood Blight.

- | | |
|--------------------|--|
| Miguel Alcantar | Gardener |
| Christan Allen | Outreach Coordinator |
| Melvin Avendano | Gardener |
| Juliana Bjorklund | Director of Operations |
| Melissa Bosdorf | Gallery Secretary |
| Sarah S. Catmur | Venue Rental Coordinator |
| Jenny Duggan | Visitor Engagement/Manager on Duty |
| Chris Emanus | Grounds Zone Manager |
| Erika Fuller | Visitor Engagement |
| Jeff Goggans | Preparator |
| Braden Hixson | Development Officer |
| Gail Hopper | Controller |
| Mitzi Igleharte | Outreach Instructor |
| Stuart Janssen | Youth Garden Instructor |
| Susan Johnson | Director of Planned Giving |
| Robert Jones | Facilities Supervisor |
| Kristen Kimberling | Registrar |
| Sarah Lorenz | Special Events Manager |
| Norma Montesi | Gardens Education |
| Glenn Overall | Bookkeeper |
| Lorenzo Perez | Gardener |
| Julie Pierotti | Curator |
| Adam Queen | Gardener |
| Kristen Rambo | Digital Communications Associate |
| Christine Ruby | Art Instructor |
| Kim Rucker | Cutting Garden/Greenhouse Manager |
| Margarita Sandino | Director of Education |
| Charity Saunders | Visitor Engagement |
| Kevin Sharp | Director |
| Corkey Sinks | Graphic Designer |
| Dale Skaggs | Director of Horticulture |
| Elizabeth Sloane | Public Program Coordinator |
| Karen Strachan | Youth Program Coordinator |
| Kori Van der Bjil | Membership Coordinator |
| Julia Waters | Outreach Instructor |
| Jesse Wiley | Director of Development and Communications |



AMY HUTCHESON
Out is Through, 2022 | Oil on canvas | 36 x 48 inches | Courtesy of the artist

Guidelines

1. Please carefully read and follow the GCA Rules, General Information and Timetable for exhibitors.
2. An exhibitor is permitted only one entry per Class, but may enter more than one Class. The exhibitor(s) under whose name(s) the entry has been registered must create and complete the design. All participants must be listed. Only listed exhibitors and show personnel may be on the show floor at the time of entry. An exhibitor must NOT leave until all of her entries are passed.
3. If forced to withdraw, an exhibitor must notify the Registration Chair and Class Consultant, and find a substitute unless there is a waiting list for the Class.
4. Mechanics should not be visible unless they are an integral part of the design.
5. All designs must be executed at the show. Complex components requiring extensive time for construction may be prefabricated and assembled at the show.
6. Anything not prohibited in the GCA Rules, Floral Design Division Guidelines or individual Class descriptions is permitted.
7. All entries must include fresh and/or dried plant material. Fresh plant material must be in water or conditioned in such a way as to remain in pristine form while on exhibition. Rooted plant material is allowed provided no soil is attached. An organic response in the use of materials is encouraged. An entry not maintained in show condition may have its award removed.
8. Although permitted, the use of cut fruits and vegetables is discouraged and should be undertaken only with proper treatment to prevent spoilage and insect contamination.
9. Accessories are permitted, unless otherwise stated in the Class description.

- 10. Entries will be staged on 40" x 15" x 15" pedestals painted antique white. Pedestal tops may be enlarged but **no more than 5"** in any direction due to space restrictions. Designs may not exceed 15" from the center of the pedestal in width or depth. No height restrictions apply. Pedestals will be appropriately placed by the Dixon curatorial staff. Pedestals may not be moved. Pedestals may have up to ½" variance from the size stated in the schedule. The designs will be viewed from 3 sides unless noted in a specific Class.
- 11. Once pertinent paint colors have been determined by the Dixon curatorial staff registrants will be notified by the Division Chair.
- 12. Questions regarding Class requirements may be directed to the Class Consultant and/or the Division Chair.
- 13. Nothing may be affixed to the wall. No part of any design may come within 12" of any piece of art.
- 14. The ceiling height of all galleries is approximately 13 feet, except for the Residence Gallery, which is 10 ½ feet and the Mallory Gallery, which is 9 feet. All galleries have a chair rail of approximately 34" from the floor except the Plough Gallery.
- 15. Upon request artwork will be emailed to exhibitor in jpeg form. Exhibitor(s) will also find the art published in the schedule. It is possible that the colors of the photographs in the schedule will not match the actual colors of the art in the show perfectly and the judges will be made aware of this.
- 16. No outside boxwood is permitted in Dixon Gallery and Gardens because Dixon is a Boxwood Trial Garden. Outside boxwood could possibly introduce the very contagious Boxwood Blight
- 17. Class organization and placement of art is at the discretion of the Dixon curatorial staff. Entries will be viewed from three sides. Exhibitors will unload entries through the main entrance of the Catmur Foyer.

- 18. **All entries may have one or two exhibitors with the exception of Class 8.** Entry forms should denote Class preference in order. First choice will be honored if available.
- 19. A Statement of Intent (25 words or less) must be submitted to Catherine Stallings , Floral Design registrant: ccstallings@bellsouth.net by Monday, March 11, 2024. A Statement of Intent is a brief written paragraph offering an explanation of the exhibit's creation.
- 20. Registration for Floral Design opens at 9:00 a.m. CST on Monday, September 11, 2023 and will close as Classes are filled OR at midnight Monday, February 12, 2024. To register, please email Catherine Stallings: ccstallings@bellsouth.net with name, GCA Club, phone number, as well as 1st and 2nd entry number preference(s). A confirmation email will be sent within 48 hours of receipt.

Class 8 fee is \$200.00 and registration is open only to out-of-town GCA judges. Please make a check payable to Memphis Garden Club. Mail to: Ruthie Bowlin, 3910 North Galloway Drive, Memphis, TN 38111 by Monday, March 11, 2024.
- 21. Judging will be based on the principles of design: balance, contrast, dominance, proportion, rhythm and scale; and the elements of design: light, space, line, form, color, texture, pattern and size. Creativity is important, as are distinction, conformance to and interpretation of the Class and schedule.
- 22. Scale of points by which Classes 1 - 11 are to be judged:

	POINTS
Design	35
Interpretation	20
Creativity	20
Distinction	15
Conformance	10
Total	100

23. For exhibitors wishing to ship materials in advance, the address is: Memphis Garden Club c/o Dixon Gallery and Gardens, 4339 Park Avenue, Memphis, TN 38117

Registration for Floral Design opens at 9:00 a.m. CST on Monday, September 11, 2023 and will close as Classes are filled OR at midnight Monday, February 11, 2024. To register, please email Catherine Stallings: ccstallings@bellsouth.net with name, GCA Club, phone number, as well as 1st and 2nd entry number preference(s). A confirmation email will be sent within 48 hours of receipt.

INQUIRIES

Questions regarding Class requirements may be directed to the Class Consultant and/or the Division Chair **by email.**

Floral Design Chair: Cary Brown | carycbrown@gmail.com



LONNIE ROBINSON
Being, 2023 | Asphaltum, metallic paints on scraped oxidized sheet metal
 44 x 65.5 inches | Courtesy of the artist

Class 1: The Ripple Effect

5 entries, Plough Gallery entry numbers 1-5

Class consultant CHRIS SANDERS | crs2154@aol.com



1. BEN BUTLER
Organelle 4, 2023
 Basswood
 48 x 36 inches
 Courtesy of the artist



2. BEN BUTLER
Organelle 3, 2023
 Red grandis wood
 36 x 48 inches
 Courtesy of the artist



3. BEN BUTLER
Organelle 2, 2023
 Walnut wood
 36 x 48 inches
 Courtesy of the artist



4. BRANTLEY ELLZEY
Barbra, 2023
 Rolled pages of Tabloid Tribute Magazines
 56 x 33 1/2 x 1 1/2 inches
 Courtesy of the artist

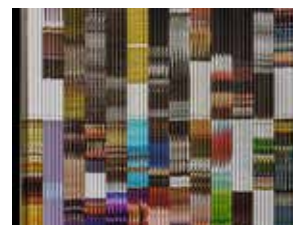

5. BRANTLEY ELLZEY
Dolly, 2023
 Rolled pages of Tabloid Tribute Magazines
 56 x 33 1/2 x 1 1/2 inches
 Courtesy of the artist

Class 2: Stringing Me Along

4 entries, Plough Gallery entry numbers 6-9

Class consultant: CHRIS SANDERS | crs2154@aol.com



6. CAT PENA
Witnessing Her Corridor, 2023
 Large format print, naturally-dyed wool yarn
 63 ½ x 63 ½ inches
 Courtesy of the artist



7. CAT PENA
Through the Fire, 2023
 Mixed media 74 x 48 inches
 Courtesy of the artist



8. NIKII BERRY RICHEY
Pink Orchid, 2022
 Mixed Media
 25 x 16 x 12 inches
 Courtesy of the artist



9. NIKII BERRY RICHEY
Sitting Still and Pretty, 2022
 Mixed media
 8 x 10 feet
 Courtesy of the artist

Class 3: Going Through the Motions

5 entries, Plough Gallery entry numbers 10-14

Class consultant: CARROLL NENON | csnenon@gmail.com



10. LONNIE ROBINSON
Triumphant, 2023
 Asphaltum, Metallic paints on scraped oxidized sheet metal
 65 ½ x 44 inches
 Courtesy of the artist



11. LONNIE ROBINSON
Pointe, 2023
 Asphaltum, Metallic paints on scraped oxidized sheet metal
 65 ½ x 44 inches
 Courtesy of the artist



12. CARL E. MOORE
Girl with Water Flowers, Part 2, 2023
 Acrylic on canvas
 48 x 48 inches
 Courtesy of the artist



13. KELLY COOK HARMON
Amber and Ruth, 2023
 Watercolor on wood
 30 x 42 inches
 Courtesy of the artist



14. KELLY COOK HARMON
We Call Her Mrs. Conway, 2023
 Watercolor on wood
 40 x 34 inches
 Courtesy of the artist

Class 4: Tripping the Light Fantastic

4 entries, Crump Gallery entry numbers 15-18

Class consultant: PAM PIERCE | pampierce9876@aol.com



15. THAD LEE
Moon Painting 41A, 2023
 Archival pigment print, 1/7
 34 x 51 inches, Framed: 40 x 57 inches
 Courtesy of the artist



16. THAD LEE
Moon Painting 51A, 2023
 Archival pigment print, 1/7
 34 x 51 inches, Framed: 40 x 57 inches
 Courtesy of the artist



17. THAD LEE
Moon Painting 80A, 2020
 Archival pigment print, 1/7
 34 x 51 inches, Framed: 40 x 57 inches
 Framed: 40 x 57 inches Courtesy of the artist



18. THAD LEE
Moon Painting 98A, 2021
 Archival pigment print, 1/7
 34 x 51 inches, Framed: 40 x 57 inches
 Courtesy of the artist

Class 5: The Answer, My Friend, Is Blowing in the Wind

5 entries, Brinkley Gallery entry numbers 19-23

Class consultant: CILE COLLIER | ccollier3027@aol.com



19. JIMPSIE AYRES
Mama, 2023
 Oil on canvas
 48 x 36 inches
 Courtesy of the artist



20. JIMPSIE AYRES
Isy of the Many Questions, 2023
 Oil on canvas
 36 x 72 inches
 Courtesy of the artist



21. LAUREL SUCSY
Goat Song, 2020
 Oil on linen
 20 x 16 inches
 Courtesy of the artist



22. EMILY OZIER
Gathered 1, 2023
 Mixed media
 36 x 36 inches
 Courtesy of the artist



23. NELSON GUTIERREZ
A Ride in the Magdalena River, 2022
 MDF and enamel
 42x48 inches
 Courtesy of the artist

Class 6: In Any Shape or Form

4 entries, Wilmott Gallery entry numbers 24-27

Class consultant: CAMILLE MUELLER | candbmueller@aol.com

The three works of art, interpreted as one, will inspire the design of a functional table. A functional table is a table exhibit arranged for dining, including dishes, glassware, linens and floral design(s) depicting a dining experience staged on a 36" round x 30" tall table. The table will be placed on a 48" square platform, which may not be altered or embellished. Tablecloth not provided. Food and Silverware are not allowed. A Statement of Intent is required and is to be submitted online at www.memphisgardenclub.org. The design may not extend beyond the platform's horizontal dimensions. The exhibit will be viewed from four sides.



24. PAM MCDONNELL
Blue Ear'd Man, 2022
Ceramic
12 x 4 x 4 inches
Courtesy of the artist



25. PAM MCDONNELL
Psychoid #4, 2002
Ceramic
10 x 7 x 5 inches
Courtesy of the artist



26. KONG WEE PANG
Connect Bloom, 2023
Watercolor on unprimed canvas
48 x 34 inches
Courtesy of the artist

Class 7: Color My World

6 entries, Phillips Gallery entry numbers 28-33

Class consultant: RUTHIE SAMAHA | ruthiesamaha@yahoo.com



28. PAM MCDONNELL
Self Portrait, 2022
Oil on linen | 48 x 48
Courtesy of the artist



29. PAM MCDONNELL
Psyche Rides the Vehicle of Individuation, 2023
Oil on canvas | 51 x 63 inches
Courtesy of the artist



30. AMY HUTCHESON
Out is Through, 2022
Oil on canvas | 36 x 48 inches
Courtesy of the artist



31. AMY HUTCHESON
Chased By the Wild Goose, 2022
Oil on canvas | 36 x 48 inches
Courtesy of the artist



32. AMY HUTCHESON
The Calm of the Crescendo, 2022
Oil on canvas | 36 x 48 inches
Courtesy of the artist



33. AMY HUTCHESON
Signal to Noise, 2022
Oil on canvas | 36 x 48 inches
Courtesy of the artist

Class 8: Loop Di Lou

5 entries, Wilmott Gallery entry numbers 34-38

Class consultant: RUTHIE BOWLIN | ruthbowlin@aol.com
 RUSSELL WHITEHEAD russellwhitehead@yahoo.com

Judges' Challenge Class



34-38. JAMOND BULLOCK
The Mountains We Climb, 2023
 Acrylic on Canvas
 72 x 96 inches
 Courtesy of the artist

Class 9: All Things Bright and Beautiful

5 entries, Wilmott Gallery entry numbers 39-43

Class consultant: MARY GASTON CATMUR | jccatmur@comcast.net



39. MIKAYLA WASHINGTON
Revive, 2023
 Acrylic on canvas
 72 x 48 inches
 Courtesy of the artist



40. JAMOND BULLOCK
Beholder, 2023
 Acrylic on canvas
 48 x 72 inches
 Courtesy of the artist



41. JAMOND BULLOCK
The Journey, 2022
 Acrylic on canvas
 48 x 60 inches
 Courtesy of the artist

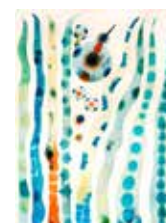

42. KONG WEE PANG
Voyeur Moment, 2023
 Watercolor on unprimed canvas
 48 x 34 inches
 Courtesy of the artist



43. KONG WEE PANG
Rain, 2023
 Watercolor on unprimed canvas
 40 x 50 inches
 Courtesy of the artist



EMYO
Gathered 3, 2023 | Mixed Media | 36 x 36 inches | Courtesy of the artist

Class 10: Happiness Blooms from Within

6 entries, Wilmott Gallery entry numbers 44-49

Class consultant: MARY GASTON CATMUR | jccatmur@comcast.net

Memphis Garden Club New Members' Class

*This Class is open to all 2022-23 new members of the
Memphis Garden Club.*



44-49. JIMPSIE AYRES
The Garden, 2023
Oil on canvas
48 x 36 inches
Courtesy of the artist

Guidelines

Please carefully read and follow the GCA Rules, General Information and Timetable for Exhibitors.

OWNERSHIP REQUIREMENTS

1. Entries must be owned and grown by the exhibitor for a minimum of 6 months (Oct. 10, 2023) unless otherwise stated in the schedule. The exceptions are listed below.
 - Classes 1-3 - Annuals (3 months)
 - Classes 130-131 - Herbs/container (3 months)
 - Classes 144-145 - Topiary (9 months)
 - Class 148 - Par Class (1 year)

Monday, April 10, 2023 One-year ownership deadline
 Monday, July 10, 2023 Nine-month ownership deadline
 Monday, October 10, 2023 Six-month ownership deadline
 Wednesday, January 10, 2023 Three-month ownership deadline
2. An exhibitor may submit 3 entries per Class, provided each is a different species or cultivar.

PLANT/SPECIMEN REQUIREMENTS

3. The maximum length of a vine/branch is 26" measured from the lip of the container to the tip end of the vine/branch, also known as the "lip to tip rule." There is an exception for the Giant Hosta Classes 26 and 27.
4. All cut specimens must be in show condition at the time of judging. Wilted specimens are subject to removal by the Horticulture Committee. See GCA Rule #3 regarding the condition of plant material.
5. Leaf shine or other commercial foliage enhancers are not permitted.
6. Bonsai are not allowed.
7. Scale of Points for Cut Arrangements (Class 111-113)

Cultural Perfection	40
Distinction	25
Variety	15
Artistic Effect	10
Key Card	10
Total	100

CONTAINER REQUIREMENTS

8. Containers are measured at the diameter or the diagonal of the widest point on the inside rim at the soil line. Container not to exceed 10". Exception to container size applies to Classes 141, 142, and 143 which are not to exceed 6". Classes 119, 122, 125, 129, 131, 134, 137, 139, 140, 146, and 147 are not to exceed 8". Classes 135 and 136 are not to exceed 12". Class 138 is not to exceed 16".
9. Container-grown plants must be exhibited in containers that are clean, unobtrusive and compatible with the exhibit. Clean terracotta clay pots are preferred. Stone like (hypertufa) are permitted. Fully disguised double potting is permitted. Worm casting top dressing will be required and will be provided in Horticulture Grooming and Receiving.
10. To designate a preferred exhibiting side, exhibitors should mark the center back of the container with a white chalk mark "X."
11. To designate the order of a container collection, white stickers will be provided for numbering or chalk should be used to indicate the number sequence.
12. Container plants must have been owned and grown by the exhibitor for a minimum of six months unless otherwise stated. (October 10, 2023)
13. Mats, stands, and saucers are not allowed. If an entry is staked (such as a forced bulb or an orchid), the support must be as unobtrusive as possible.

ENTRY CARDS

14. Entry cards are available for download from memphisgardenclub.org or from GCAMerica.org, or available from the Division Chairs or the Horticulture Committee in advance of the show and at the show.
15. Entry cards printed from memphisgardenclub.org or gcamerica.org should be printed on white card-stock.
16. An entry card must include the name of the exhibitor, division, Class, botanical and common names, and length of ownership. Entry cards must be printed in pencil or generated by computer in black ink.

ENTRY CARDS

17. All plant material must be correctly identified with the botanical and common names. Accepted references for nomenclature are:
 - www.missouribotanicalgarden.org/plantfinder
 - www.rhs.org.uk/plants/search-form
 - www.Daffseek.org (The American Daffodil Society)
 - www.hostalibrary.org (Encyclopedia of Hostas)
18. A key card (diagram or plant list) is required when multiple species or cultivars are exhibited in the same container. Key card must be on a 4" x 6", white, unlined card and completed in pencil. A 4" x 6" photograph with identifying numbers may be used to supplement the key card. See GCA website link for required information.
https://www.gcamerica.org/_uploads/filemanager/common/document/Entering_Flower_Shows/How%20to%20Complete%20a%20Key%20Card%2006.28.19.pdf
19. A GCA horticulture propagation card should accompany the entry card if applicable to the entry. Propagation cards are available for download from memphisgardenclub.org and from GCAmerica.org and printed on white cardstock. The card should be legible, identifying the method and relevant date(s) of propagation, printed in pencil or generated by computer in black ink.
https://www.gcamerica.org/_uploads/filemanager/common/public/file/Horticulture/Hort%20Prop%20Card%20Spring%202018%20FILLABLE%20extended.pdf
20. Entries eligible for the **Elizabeth Platt Corning Medal** and/or the **Louise Agee Wrinkle Horticulture Propagation Award** must be owned and grown by the exhibitor for at least 6 months (October 10, 2023) and will be identified by a checkmark on the entry card.
21. Entries eligible for the **Novice Award** also will be identified by a checkmark on the entry card. A novice is an individual exhibitor who has not won a first-place ribbon or a GCA Special Award in Horticulture of a GCA Major Flower Show or Sanctioned non-GCA Major Flower Show.

ENTRY PROCESS

22. Only GCA club members, Museum personnel, and plant experts approved by the Horticulture Division Chairs may be in the passing area of the Show. Only GCA club members may participate in the entry process. Exhibitors bear the ultimate responsibility for their own entry.
23. Entries will be received through the back door located behind the Winegardner Auditorium and Canale Kitchen on the east side of the building. See the map at the end of the schedule.
24. The Horticulture Committee will provide bottles; The Dixon will provide all wedging material for all cut specimens. Wilted specimens are subject to removal by the Horticulture Committee.
25. Once entry is passed, a sticker with the entry number will be affixed to the back of the specimen stand or container. This number will be written on the corresponding entry card, and if applicable, the key and propagation cards.
26. The Horticulture Committee will water the exhibits if instructed to do so with written instructions provided at the time of entry.
27. Once an entry has passed, it may not be touched by anyone other than the Placement Committee, the Horticulture Chairs, the Show Chairs, or the Clerks.
28. Classes may be subdivided and entries moved and/or reclassified at the discretion of the Horticulture Committee or Judges.

JUDGING

29. A list of the recommended scale of points by which the Classes are to be judged can be found in *The Garden Club of America Flower Show and Judging Guide Book*, July, 2022 Edition.

REMOVAL

- 30. Removal of entries will take place on Sunday, April 14 from 5:15pm to 6:00pm and on Monday, April 15 from 9:00am to 12:00pm. All items left after 12:00 p.m. on Monday will be discarded unless arrangements have been made with the Container Return Chairs. Remaining flowers will be arranged and delivered to Memphis Garden Club Life Members and Memphis retirement communities.
- 31. Out-of-town entry cards will be mailed to the exhibitor after the flower show.

INQUIRIES

Questions regarding Class requirements may be directed to the Class Consultant and/or the Division Chair by email.

Horticulture Chair: Gwin Erb gwnerb@yahoo.com
Co-Chairs: Caroline Orr carolineorr@me.com
 Elizabeth Dickinson edickinson007@comcast.net

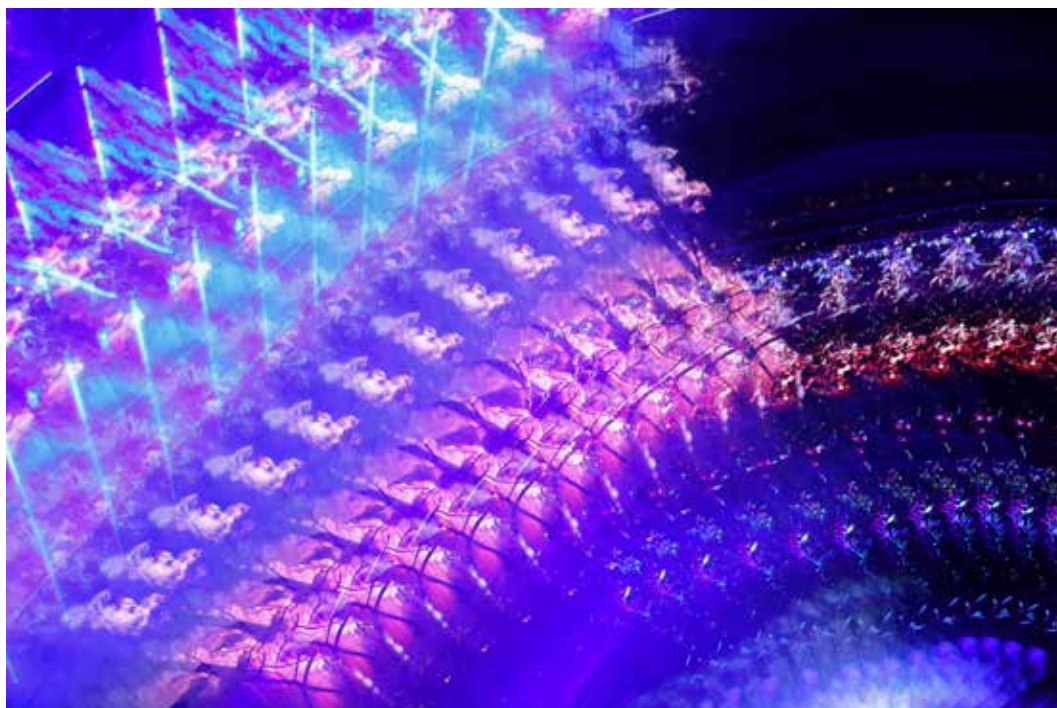

THAD LEE
Moon Painting 51A, 2020 | Archival pigment print, 1/7 | 34 x 51 inches
 Framed: 40 x 57 inches | Courtesy of the artist

Division II-A | Horticulture

WINEGARDNER AUDITORIUM

CLASSES 1-113: CUT SPECIMENS

One stem or branch must not exceed 26" length, from the lip of the container to the tip of the stem (lip to tip rule, unless an exception is stated in Class Description. Any foliage must be attached to the stem. No foliage under water.

CLASSES 1-3. ANNUALS

An annual is a plant that completes its life cycle in one growing season.

Blooming

- 1. Single stem
- 2. Three stems, same species or cultivar

Foliage

- 3. Single stem

CLASSES 4-38: PERENNIALS

A perennial is a plant that lives for more than two growing seasons.

Blooming: One flowering stem – any foliage must be attached

- 4. *Amsonia* (blue star)
- 5. *Aquilegia* (columbine)
- 6. *Baptisia* (false indigo)
- 7. *Bletilla* (ground orchid)
- 8. *Helleborus* (Lenten rose) any stage
- 9. *Lamprocapnos* (formerly *Dicentra*) (bleeding heart)
- 10. *Myosotis* (forget me not)
- 11. *Polygonatum odoratum* (Solomon's seal)
- 12. Other

Peonies:

- 13. *Paeonia suffruticosa* (tree peony)
- 14. *Paeonia lactiflora* (herbaceous peony)
- 15. *Paeonia hybrid* (itoh, intersectional peony)

CLASSES 4-38: PERENNIALS continued**Foliage:** single stem Ferns:

16. *Adiantum* (maidenhair fern)
17. *Athyrium niponicum* (Japanese painted fern)
18. *Dryopteris marginalis* (wood fern)
19. *Dryopteris erythrosora* (autumn fern)
20. *Polystichum polyblepharum* (tassel fern)
21. Other

Herbs:

22. *Mentha* (mint)
23. *Origanum* (oregano)
24. *Salvia rosmarinus* (rosemary)
25. Other

Hosta:

The “lip to tip rule” for Classes 26 and 27 has been extended to 30” from the lip of the container to the tip of the leaf.

Giant – 144 square inches

26. Non-variegated
27. Variegated

Large – 81-144 square inches

28. Non-variegated
29. Variegated

Medium – 25-81 square inches

30. Non-variegated
31. Variegated

Small – 6-25 square inches

32. Non-variegated
33. Variegated

Miniature – 2-6 square inches

34. Non-variegated
35. Variegated

Other Foliage:

36. *Farfugium japonicum* (formerly *Ligularia* - leopard plant)
37. *Heuchera* (coral bells)
38. Other

CLASSES 39-57: BULBS, CORMS, RHIZOMES, AND TUBERS

Definitions, per *Garden Club of America Flower Show & Judging Guide 2022 Glossary of Terms*:

Bulb: a modified underground stem, which is typically very short, flattened and sur- mounted by a group of usually fleshy, non-green, scale-like leaves. Bulbs are sometimes covered by a thin membranous layer, e.g., onions and tulips, or fibrous and reticulated, tunic, e.g., Allium, or the scales may be naked, e.g., Liliium.

Corm: a bulb-like, swollen underground stem stored with reserved food and bearing buds and growing shoots on its surface such as Crocus, Gladiolus, Cyclamen, Colchicum.

Rhizome: a thick horizontal stem (under and above the ground) which forms roots, stores food, and sends up leaves and flowering stalks.

Tuber: a swollen underground stem, usually rounded, with buds or “eyes” from which new plants or tubers are produced, e.g., potato.

Daffodils (*Narcissus*):

39. Division I: Trumpet
40. Division II: Large-cupped
41. Division III: Small-cupped
42. Division IV: Doubles
43. Division V: Triandrus
44. Division VI: Cyclamineus
45. Division VII: Jonquilla
46. Division VIII: Tazetta
47. Division IX: Poeticus
48. Division X: Bulbocodium
49. Division XI: Split Corona
50. Division XII: Other
51. Division XIII: Botanical Names (species)

Other Bulbs, Corms, Rhizomes, and Tubers:

52. *Arum*
53. *Convallaria* (lily of the valley)
54. *Iris*
55. *Leucojum* (snowflakes)
56. *Tulipa* (tulip)
57. Other

CLASSES 58-64: ROSES

One flowering stem, except where noted – must be exhibited with at least one attached leaf containing five leaflets as identified by the American Rose Society.

- 58. Species Roses
- 59. Old Garden Roses (prior to 1867)

Modern Roses:

- 60. Floribunda and Climbing Floribunda
- 61. Grandiflora and Climbing Floribunda
- 62. Hybrid Tea and Climbing Hybrid Tea
- 63. Miniature and Climbing Miniature
- 64. Other

CLASSES 65-99. SHRUBS

Woody plants in bloom, berries or foliage.

Single branch – Any foliage must be attached to the stem. All plants grown for flowers must be shown in bloom. Plants grown for foliage may have incidental flowers but leaves must predominate. Displayed branches may not exceed 26” from the lip of the container to the tip of the longest branch.

Shrubs –Blooming**Rhododendrons: species and cultivars**

- 65. Species
- 66. Other

Educational note: All Azaleas are *Rhododendrons* but not all *Rhododendrons* are Azaleas.

Rhododendrons (Azaleas) cultivars/varieties**Azaleas – White varieties**

- 67. ‘Delaware Valley’
- 68. ‘G.G. Gerbing’
- 69. ‘Glacier’
- 70. ‘Snow’
- 71. Other

Azaleas – Pink, Red, and Orange varieties

- 72. ‘Amy’
- 73. ‘Coral Bells’
- 74. ‘George L. Taber’
- 75. Other

Azaleas – Lavender and Purple varieties

- 76. ‘Formosa’
- 77. Other

Azaleas – Other Azaleas

- 78. Native
- 79. Exbury
- 80. Other

Viburnum

- 81. *V. macrocephalum*
- 82. *V. opulus ‘sterile’*
- 83. *V. x burkwoodii*
- 84. *V. carlesii*
- 85. *V. x juddii*
- 86. *V. plicatum*
- 87. Other

Other Shrubs – Flowering

- 88. *Chaenomeles* (flowering quince)
- 89. *Hydrangea macrophylla* (big leaf)
- 90. *Hydrangea quercifolia* (oakleaf)
- 91. Spiraea
- 92. Syringa (lilac)
- 93. Other

Shrubs – Foliage

- 94. Conifer
- 95. Non-variegated
- 96. Variegated
- 97. Berried/Fruited, must display berries or fruit
- 98. Evergreen
- 99. Other

CLASSES 100-107: TREES

Trees – Flowering

- 100. *Aesculus pavia* (red buckeye)
- 101. *Prunus* (cherry)
- 102. Other

Trees – Foliage

- 103. Deciduous
- 104. Evergreen
- 105. Conifer—encouraged to have cones
- 106. Berried/Fruited, must display berries or fruit
- 107. Other

CLASSES 108-110: VINES

No invasive cultivars

- 108. *Clematis* (clematis)
- 109. *Lonicera sempervirens* (honeysuckle)
- 110. Other

CLASSES 111-113: AN ARRANGEMENT OF CUT SPECIMENS

Cut specimens from the exhibitor’s garden arranged in a clear glass container provided by the exhibitor. The maximum length of an entered vine/branch is 26” measured from the lip of the container to the tip end of the vine/branch. Minimum of 3 species or cultivars. Key card required. Scale of points is in the Plant/ Specimen Requirement Guide.

- 111. Flowering
- 112. Foliage
- 113. Mixture of flowers and foliage

CLASSES 114-134: CONTAINER GROWN PLANTS

Containers may include more than one plant of the same species or cultivar except where noted. Containers not to exceed 10” except where noted. Key cards are required when multiple species are exhibited in the same container.

CLASSES 114-119: FLOWERING CONTAINERS

CLASSES 114-116: FLOWERING ORCHIDS

One or more specimens in bloom per container. Clay or terra cotta containers, baskets, or bark slabs are recommended. Exhibitors must have owned the entry for at least a year.

- 114. Epiphytic
- 115. Terrestrial
- 116. Other

CLASSES 117-119: OTHER FLOWERING CONTAINER PLANTS

- 117. One specimen per container
- 118. More than one of the same species or cultivar per container
- 119. Collection of flowering plants, three to seven different species or cultivars, grown in separate containers, not to exceed 8”

CLASSES 120-134: FOLIAGE CONTAINERS

CLASSES 120-122: BEGONIAS

- 120. One specimen per container
- 121. More than one of the same species or cultivars per container
- 122. Collection, three to seven different species or cultivars grown in separate \ containers, not to exceed 8”

CLASSES 123-125: CACTI AND OTHER SUCCULENTS

One year ownership requirement.

- 123. One specimen per container
- 124. More than one of the same species or cultivar per container
- 125. Collection, three to seven different species or cultivars grown in separate containers, not to exceed 8”

CLASSES 126-129: FERNS

One species or cultivar per container

- 126. *Adiantum* (maidenhair)
- 127. *Nephrolepis* and variations (Boston)
- 128. Other
- 129. Collection, three to seven species or cultivars grown in separate containers not to exceed 8”

CLASSES 130-131: HERBS

Three-month ownership requirement

- 130. One specimen per container
- 131. Collection, three to seven different species or cultivars grown in separate containers, not to exceed 8"

CLASSES 132-134. OTHER FOLIAGE CONTAINER PLANTS

- 132. One specimen per container
- 133. More than one of the same species or cultivar per container
- 134. Collection, three to seven different species or cultivars grown in separate containers, not to exceed 8"

CLASSES 135-148: OTHER CONTAINER GROWN PLANTS DISTINCT TO MGC SHOW FOR 'RHYTHM AND HUES'**CLASSES 135-136. FAMILY CLASSES: "WE ARE FAMILY"**

Three month ownership requirement.

Any plant or plants, which have been owned by the exhibitor for a minimum of three months or longer. May be entered by family members of the GCA Clubs, Memphis Garden Club and The Little Garden Club of Memphis. Container not to exceed 12".

- 135. Plants – flowering and must be in bloom
- 136. Plants – foliage

CLASSES 137-138: IMMEMORIAL: "PRETTY WOMAN"

A plant notable for her age, grace and beauty.

Five-year ownership requirement

- 137. Small container, not to exceed 8"
- 138. Large container must be at least 10", but not to exceed 16"

CLASS 139-140: MATCHING MULTIPLES: "MIRROR MIRROR ON THE WALL"

Pairs and Triples – should look exactly alike – "mirror image"

- 139. Two plants of the same species or the same cultivar, grown in separate containers, not to exceed 8"
- 140. Three plants of the same species or the same cultivar grown in separate containers, not to exceed 8"

CLASSES 141-142: MINIATURES: "TINY DANCER"

A showcase for the "itty bitties".

A mature example of a plant that is naturally diminutive. Showcase for the "itty bitties". Container not to exceed 6".

- 141. Flowering
- 142. Foliage
- 143. Collection of miniatures, three to seven different species or cultivars grown in separate containers, not to exceed 6"

CLASSES 144-145: TRAINED PLANTS: "PEACE TRAIN"

Nine-month ownership requirement.

- 144. Standard topiary, a single straight stem
- 145. Trained topiary on form, one or more of the same species per container

CLASSES 146-147: CLUB WORKSHOPS**CLASS 146: PROVISIONAL PAPYRUS PROPAGATION: "QUEENTUT"**

Challenge workshop for first and second year provisionals of the Memphis Garden Club. Papyrus "Queen Tut" cuttings were distributed to provisional members at a workshop in October 5, 2023 and the Dixon. Provisional members were instructed on propagation methods, rooting, planting, and growing the papyrus. Horticulture Committee mentoring continued through each of the growing and up-potting stages. GCA propagation card required. Containers provided and not to exceed 8".

- 146. Single plant per container.

CLASS 147: TOADSTOOLS IN THE GARDEN: "JERIMIAH WAS A BULLFROG"

Challenge workshop for members of the Memphis Garden Club.

Toadstool forms were provided to Memphis Garden Club members at a workshop in September 28, 2023 at the Memphis Botanic Garden. Plants and containers also provided, containers not to exceed 8". One or rooted plugs of the same species or cultivar with a maximum of 5 rooted plugs must be grown and shaped by the exhibitor on the toadstool structure. No accessories permitted.

- 147. Ficus pumila

CLASS 148: PAR CLASS “ANYTHING GOES”

Open to an exhibit of outstanding horticultural merit, which does not qualify for entry elsewhere in Division II-A. Horticulture entries in a Par Class are individually judged against perfection rather than against each other. Exhibitors must have grown an entry for at least one year. Container size is unlimited and does not have to conform to specified clay or terracotta colored container requirements. Cut specimens and hanging plants are not allowed.

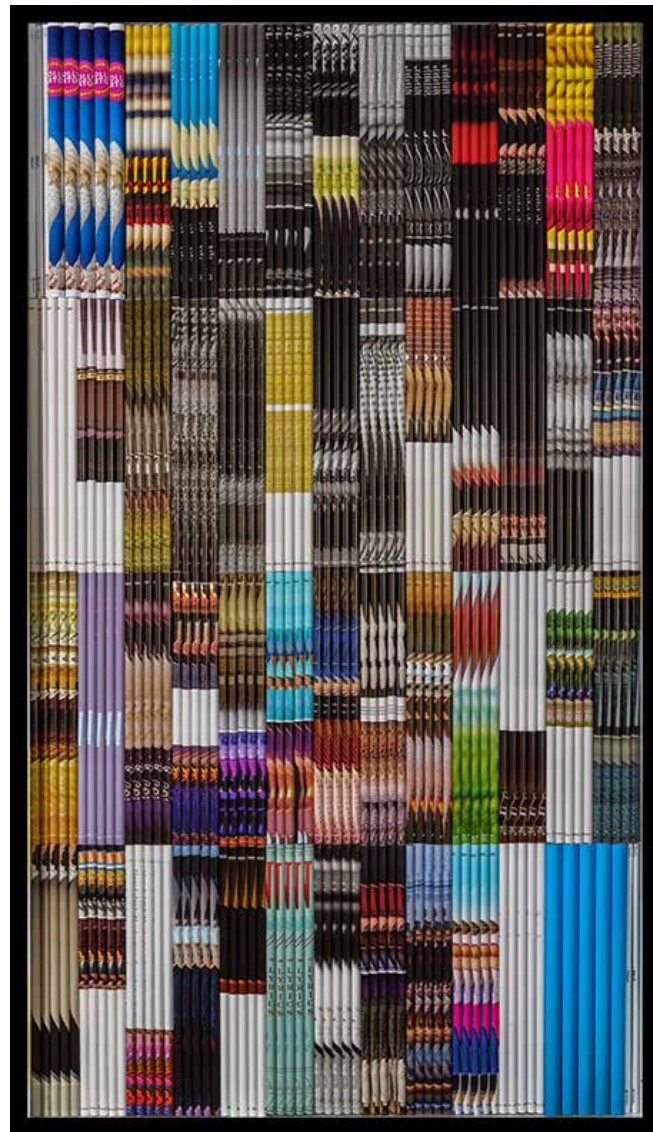

BRANTLEY ELLZEY
Dolly, 2023
 Rolled pages of
 Tabloid Tribute
 Magazines
 56 x 33 ½ x 1 ½ inches
 Courtesy of the artist

Guidelines

1. Please carefully read and follow the GCA Rules, General Information, and Time- table for Exhibitors.
2. Registration is online at www.memphisgardenclub.org. and begins on Monday, September 11, 2023 through Monday, February 12, 2024.
3. Fee payment shall be made at time of online registration. Demonstrative workshop(s) will be held on February 1, 2024 at the Dixon in Memphis, Tennessee regarding Classes 1-4.
4. Containers are provided in Classes 1-4 upon registration and will be available for pickup in Memphis, Tennessee. Containers may be shipped to out of town registrants at the registrant’s expense. No structural alteration of the provided containers is permitted.
5. There are no dates of ownership requirements for plant material. No exhibitor may win Best in Show unless plant material has been owned by the exhibitor for a minimum of three (3) months, January 10, 2024.
6. Live, rooted material must dominate the design. No cut flowers are allowed.
7. Accessories are permitted in Classes 2 and 3.
8. Exhibitors are permitted only one entry per Class, but may enter more than one Class. No more than 2 exhibitors may execute an entry. Each exhibit must be the work of the exhibitor(s) under whose name(s) it has been registered. All participants must be listed on the entry form. Only listed exhibitors may be on the show floor at the time of entry.
9. Horticulture Design entries will be passed once they are in place. Once an entry is passed, the exhibitor(s) must immediately leave the show floor. Entries must be placed and passed on Wednesday, April 10, 2024 from 12 p.m. to 4 p.m.
10. If forced to withdraw, an exhibitor must notify the Division Chairs and then find a substitute, unless there is a waiting list for the Class.
11. A Statement of Intent is required. It must be no more than 25 words on a white, unlined, 4” x 6” card and it must be printed (by hand or computer) in black waterproof medium.
12. Should a registrant need to withdraw it is the responsibility of the registrant to find a replacement exhibitor so that GCA Class requirements are met.

ENTRY CARDS

- 13. Entry cards are available for download from www.memphisgardenclub.org or from www.GCAmerica.org or available from the Division Chairs or the Horticulture Committee in advance of the show and at the show.
- 14. Entry cards printed from www.memphisgardenclub.org or www.gcamerica.org should be printed on white card-stock.
- 15. An entry card must include the name of the exhibitor, division, Class, botanical and common names, and length of ownership. Entry cards must be printed in pencil or generated by computer in black ink.
- 16. All plant material must be correctly identified with the botanical and common names. Accepted references for nomenclature are:
 - www.missouribotanicalgarden.org/plantfinder
 - www.rhs.org.uk/plants/search-form
 - www.Daffseek.org (The American Daffodil Society)
 - www.hostalibrary.org (Encyclopedia of Hostas)
- 17. A key card is required when multiple species or cultivars are exhibited in the same container. Key card must be on a 4" x 6", white, unlined card and completed in pencil. A 4" x 6" photograph with identifying numbers may be used to supplement the key card. See GCA website link for required information. https://www.gcamerica.org/_uploads/filemanager/common/document/Entering_Flower_Shows/How%20to%20Complete%20a%20Key%20Card%2006.28.19.pdf
- 18. A GCA horticulture propagation card should accompany the entry card if applicable to the entry. Propagation cards are available for download from www.memphisgardenclub.org and from GCAmerica.org and printed on white cardstock. The card should be legible, identifying the method and relevant date(s) of propagation, printed in pencil or generated by computer in black ink. https://www.gcamerica.org/_uploads/filemanager/common/public/file/Horticulture/Hort%20Prop%20Card%20Spring%202018%20FILLABLE%20extended.pdf

Scale of points by which Classes 1 - 4 are to be judged:

	POINTS
Cultural Perfection	40
Scale, Balance and Design	35
Suitability and Compatibility of Plant Material	15
Suitable Key Card	10
Total	100

All entries must be removed Monday, April 15, 2024 between 9:00 a.m. and 12:00 p.m.

INQUIRIES

For any questions, please contact one of the Horticultural Design Chairs.

Horticulture Design Chairs:

Caroline Orr	carolineorr@me.com
Elizabeth Dickinson	edickinson007@comcast.net



BEN BUTLER
Organelle 3, 2023 | Red grandiswood | 36 x 48 inches | Courtesy of the artist

Division II-A | Horticulture

WINEGARDNER AUDITORIUM

Class consultant: CAROLINE ORR | carolineorr@me.com
ELIZABETH DICKINSON | edickinson007@comcast.net

Class 1: Vertical Garden

6 entries

This garden design provides an efficient use of water with an organization of plants requiring similar water needs.

This planter, consisting of 3 stacking containers, 12 planting locations and a bottom self-watering design, will be staged on top of an ivory base (40" x 15" x 15") viewed from all sides and above. A minimum of two different species or cultivars are required. The planter's dimensions are 12" x 12" x 18".

\$35.00 Fee for Vertical Garden and (optional) Workshop

Class 2: Glass Terrarium

6 entries

This terrarium provides a balanced moisture environment in a self-sustaining ecosystem.

Create a collection of rooted plant material to be displayed within a (12" H x 8" D) terrarium. A minimum of three (3) species are required. The terrarium will be staged on top of an ivory base (40" x 15" x 15") viewed from all sides and above.

\$75.00 Fee for Glass Terrarium and (optional) Workshop

Class 3: Garden Design

6 entries

This garden design reminds the viewer that every seed from sprout to bloom begins with the catalyst of water.

Create a miniature garden with rooted material interpreting three paintings as one from a projection of the original artwork using a minimum of five (5) rooted live plant materials. Exhibitor(s) will be provided with a (16" D x 6" H) galvanized container. All exhibits will be viewed from all sides and above. Exhibitors may exhibit with a partner.

\$75.00 Fee for Garden Design and (optional) Workshop



EMYO
Gathered 2, 2023
Mixed media
36 x 36 inches
Courtesy of the artist



EMYO
Gathered 3, 2023
Mixed media
36 x 36 inches
Courtesy of the artist



EMYO
Gathered 4, 2023
Mixed media
36 x 36 inches
Courtesy of the artist

Class 4: Raised Garden Planter

6 entries

This planter helps children connect the relationship between the water cycle and all edible plants.

Plant an edible garden with a young partner under the age of twelve to be displayed in a raised garden bed planter. The planter will be viewed from all sides. A minimum of three species or cultivars must be used. The dimensions of the planter are 23 ½" x 10 ½" x

17 ½". Limited to members of the Little Garden Club and MGC.

Fee for Raised Garden Planter and Workshop (optional): \$75.00

Guidelines

1. Please carefully read and follow the GCA Rules, General information and the Time- table for Exhibitors.
2. This is a juried show. The first 16 online registrations for each Class (by date and timestamp of registration) will be accepted for evaluation by the jury. The jury will choose six finalists in each Class. An exhibitor may submit only one entry in a Class but may enter two Classes.

REGISTRATION

3. Photography email registration will open on Sunday, October 1, 2023 and will close as Classes fill OR on Wednesday, January 10, 2024. The photography registration form and a place to upload the digital image will be found at www.memphisgardenclub.org. Both the form and the image must be submitted at the same time.
4. The photographs should be submitted in JPEG format. 1MB – 5MB in the sRGB colorspace. Each photograph must include the entrant's last name, first initial, zone and Class number (e.g. Brownlow|Zone|XClass1). Questions regarding this process should be directed to Irene Brownlow, irenebrownlow2@gmail.com.
5. Exhibitors will be notified by email that their registration and image have been received.
6. The finalists and non-finalists will be notified of juried results by Thursday, February 8, 2024.

PHOTOGRAPHIC REQUIREMENTS

7. A photograph previously entered in a GCA, GCA Major, Sanctioned Non-GCA Major Flower Show or a GCA Focus online contest may not be entered again even with slight alterations and reprinting. This includes photographs entered in juried shows that did not pass into the finalist stage. The same photograph may only be entered in one show at a time. If a photo is not advanced as a finalist in Juried Judging, it may be entered into a second Juried FS, a GCA FS, a GCA Major FS, or a Club Show. Editing is allowed.

8. A photograph that has been entered into a Club Show, may be entered again into a GCA Show, Zone Show, GCA Major Show or a Sanctioned Non-GCA Major Show, unless that photograph was submitted for publication in the Focus photography gallery or a printed issue of Focus.
9. Only the Photography Committee may reclassify an entry, but only with the permission of the exhibitor.
10. Each photograph must be the work of the exhibitor under whose name it is registered. In manipulated photographs, any added imagery must be the work of the exhibitor. Non-representational commercial overlays and textures are allowed.

Mounting and printing may be done professionally.
11. Editing at any stage must be the work of the exhibitor under whose name it is registered. This includes enhancement for color or clarity, removal of a part of the image, combining images, or distorting the original subject. All post production must be done before the photograph is submitted for jurying.
12. Photography entries are limited to subjects consistent with The Garden Club of America interests such as horticulture, floral design, gardens/landscapes, conservation and the environment, historic preservation, civic improvement and the natural world. Plant material is not required but is strongly encouraged in photographs.
13. All photographs must be 2-dimensional and printed on paper unless otherwise specified. Photographs must be flush-mounted on black foam core and may not be over-matted. This may be professionally done. Overall dimension of entry must be a minimum of 48" and not exceed 72" in total perimeter measurement. Surface finish is the choice of the exhibitor. Glass and framing are not permitted.

FINALISTS' ENTRY PROCESS

- 14. The printed photograph must match, including cropping, the digital image sent with the original registration. Once juried, you may not further edit or manipulate the digital image in any way, as registered with us. The photo will not be passed if the Photography Committee determines:
 - The print is significantly different from the digital submission.
 - The print is mounted incorrectly
 - The mounted print does not appear to be in Show condition.
- 15. Finalists' printed photographs must be received no later than Monday, March 11, 2024. Send photographs to:

Ferrin Mavar
4728 Spottswood Ave., No. 211
Memphis, TN 38117

Receipt of your photograph will be acknowledged. For information, contact Ferrin Mavar, ferrintmavar@gmail.com or Irene Brownlow, irenebrownlow2@gmail.com.
- 16. POSTAGE: Please include a \$15 check, payable to Memphis Garden Club to cover return postage and handling. Or you may enclose stamps, UPS labels, or postage meter strips. If a return envelope and postage are not included, it will be assumed that the image will not be returned. If the photograph will not be returned, to receive a comment card and any award won, include a self-addressed and stamped envelope. Any award received will be noted on the back of the mount before it is returned.
- 17. Recommended: Use two 15" x 19" bubble wrap envelopes, or a reusable mailing box. (Smaller envelopes are too tight to easily get images in and out with their various wrappings.) Wrap your mounted image between 2 suitable pieces of foam core (this is very light) or non-bendable cardboard, which will be reused for return. Place wrapped image inside reusable mailing box, or inside mailing envelope with folded self-addressed return envelope.

- 18. Each entry must have the entry card affixed to the back of the photograph mounting with the exhibitor's name, garden club, zone, email, address, phone number and Class entered. The top of the photograph must be indicated. See attached link to GCA entry card. https://www.gcamerica.org/_uploads/filemanager/common/document/FlowerShowCommittee_Uploads/2018EntryCards/Photography%20Spring%202018%20Fillable%20extended.pdf
- 19. A title or statement of intent may be included (but is not required) on the entry form and entry card itself not to exceed 25 words.
- 20. All photographs will be passed by the photography committee to verify that Class specifications have been met. If a photograph is not passed, the exhibitor will be notified and allowed, if time permits, to send a replacement photograph.
- 21. Photos will be hung on the wall in the Dixon Gallery. The Dixon often paints the walls for a new exhibition and the color will not be known in advance.
- 22. The division chair will provide an entry card to be staged with each photograph. Identification of plant material on the entry card is not required but encouraged whenever possible.
- 23. Only appropriate images of a child or children should be submitted to, passed and exhibited in the Photography Division and published in Focus. Featuring identifiable people (other than street scenes) in photographs is discouraged as GCA requires a release.

JUDGING

The scale of points by which the Classes are to be judged:

	POINTS
Creativity	25
Composition	25
Technical Skill	20
Conformance/Interpretation	20
Distinction	10
Total	100

The scale of points for creative techniques Classes only:

	POINTS
Creativity	30
Composition	20
Technical Skill	25
Conformance/Interpretation	10
Distinction	15
Total	100

REMOVAL

- 24. All entries must be removed from the show on Sunday, April 14, 2024 after 5:15 p.m.
- 25. A follow-up email will be sent to all photography exhibitors listing the results of the Photography Division by Sunday, April 14, 2024.

INQUIRIES

By email at any time.

Photography Co-Chairs:

Irene Brownlow irenebrownlow2@gmail.com
 Lindsay Lewis lindsayhewis@yahoo.com

Class Consultant:

Lysbeth Francis: ldkfrancis@aol.com

Committee:

Rose Garrett rosejgarrett@gmail.com
 Ferrin Mavar ferrintmavar@gmail.com
 Maryan Mercer maryanmercerc@gmail.com
 Edie Robinson ediemrt@aol.com
 Adele Wellford adelewellford@mac.com

Division III | Photography

DUNAVANT AND WETTER GALLERIES

Class consultant: LYSBETH FRANCIS | ldkfrancis@aol.com

Class 1: Water Follies

Color, Novice Class, 6 entries

An image of lively theatrics in nature

A novice is an individual exhibitor who has not won a first place ribbon or a GCA Special Award in the division entered at a GCA Flower Show, GCA Major Flower Show, or Sanctioned Non-GCA Major Flower Show. An exhibitor winning a first place ribbon in a GCA Flower Show is still considered a novice in a GCA Major Flower Show, or in a Sanctioned Non-GCA Major Flower Show, or in another division of any flower show.

An exhibitor who has won a first place ribbon or Special Award in a GCA Major Flower Show or Sanctioned Non-GCA Major Flower Show is no longer a novice in any level of GCA Flower Shows in the division won. Only individual novice exhibitors are eligible to receive the GCA Novice Awards or the Sandra Baylor Novice Floral Design Award. A novice exhibitor will be identified on the entry card, following the initial judging.

Class 2: Trove of Wonders

Macro, Close-up, Color, 6 entries

An image of a pond treasure

Macro: a macro photograph is one in which the size of the subject on the negative or image sensor is life-size or greater.

Close-up: a photo taken close to the subject or with a long focal-length lens to permit a close and detailed view of the object. The object fills most of the frame.

Class 3: Listen to the Symphony

Color, Landscape, 6 entries

An image that captures the melodies of color

Landscape: a view of the scenery of any kind from wilderness vistas to urban cityscapes, land, or sea. Primary subject is the scenery, and it must dominate although the image may contain secondary elements such as people, animals, or objects. City elements predominate in cityscapes; sea predominates in seascapes.

Class 4: River of Dreams

Color, Creative Technique, 6 Entries

An image capturing an illusion

Creative Techniques: the use of manipulation or alteration in any stage of the photographic process to achieve an effect that the original subject is no longer discernible or reflective of reality. All representational images in a manipulated or creative technique photo must be the work of the photographer. Non-representational enhancements such as the addition of purchased textures are allowed. Creative techniques may be entered in any Class.

Class 5: Floating Feather

Color, 6 Entries

An image of buoyant motion

Class 6: Fisheye

Monochrome, Fisheye lens, 6 Entries

An exaggerated image

Monochrome: an image is considered to be monochrome only if it gives the impression of having no color (e.g., contains only shades of gray which can include pure black and pure white) OR it gives the impression of being a grayscale image that has been toned in one color across the entire image. (For example, sepia, red, gold, etc.) A grayscale or a multi-colored image modified or giving the impression of having been modified by partial toning, multi toning, or by the inclusion of spot coloring does not meet the definition of monochrome and shall be classified as a color image.

Fisheye: An image created using a fisheye lens. Fisheye lens is a camera component used for shooting extremely wide angles typically 180 degrees. Also referred to as a “super wide” or “ultra-wide” lens, it produces an image that appears distorted, giving it a more abstract yet dynamic aesthetic. The subject looks like how you would think the fish would see them. (credit to www.studiobinder.com)

Guidelines

1. Please carefully read and follow the GCA Rules, General Information and Timetable for Exhibitors.
2. Registration is open from Monday, September 11, 2023 to Monday, February 12, 2024. Email registration to Elizabeth Coors at ehcoors@comcast.net. Entries will be notified of their inclusion by email. Make check payable to Memphis Garden Club and mail to Elizabeth Coors
388 River Oaks Rd.
Memphis, TN 38120.
3. Exhibitors are permitted only one exhibit in each Class, but may enter more than one Class.
4. No more than two exhibitors may execute a Botanical Arts entry. All participants must be listed on the entry card. All handiwork must be executed by the exhibitor(s). Should a registrant need to withdraw it is the responsibility of the registrant to find a replacement exhibitor so that GCA Class requirements are met.
5. If forced to withdraw, the exhibitor must notify the Division Chair and find a substitute unless there is a waiting list for the Class.
6. All plant material used must be **dried** - this includes flowers, foliage, seeds, pods, nuts (in or out of shells), vegetables, twigs, vines, reeds, etc. Only plant material, mechanics and their surface treatments (i.e. paints, nail polishes, varnishes, waxes, etc.) are permitted. Artificial, endangered and locally invasive plant materials may not be used. **Glitter may not be used unless incorporated into a paint.**
7. Figural forms must be assembled or judiciously carved by the exhibitor. Any plant material may be cut, incised or shaped to enhance artistic effect.
8. Non-plant material (i.e. cardboard, metal, twine, string, cording, etc.) may be used only for construction and must not show.
9. Anything not prohibited in the GCA Rules, Botanical Arts Division Guidelines, or individual Class descriptions is permitted.
10. Processed products may not be included in design, (i.e. couscous, tapioca, balsa wood, ground cinnamon, ground coffee or ground pepper, etc.)

11. A sample card with an untreated sample of each plant material used in the design, correctly identified with botanical and common names, affixed to a 4"x 6", white, unlined card.
12. All **mailed** entries must include a photograph and entry card and must be received no later than Monday, March 18, 2024. Entry cards are available for download from from GCAmerica.org, Send entries to:

Ainslie Todd
3170 Southern Ave., #6E
Memphis, TN 38111

If an exhibit is to be returned, the exhibitor must provide a self-addressed return label, return postage, and packing material. The Memphis Flower Show is not responsible for any damages during shipping.
13. **Hand-delivered** entries are due Thursday, April 11, 2024, 9:00 a.m. - 12:00 p.m. to the Living Room at the Dixon Gallery and Gardens.
14. If an entry has won first place or a special award in a GCA or GCA Major Flower Show, or a sanctioned non-GCA Flower Show, it may not be entered in competition again. An exhibit which has been previously entered and did not place first may be entered again if the piece is significantly altered.
15. All entries will be reviewed by the Botanical Arts Chairs to verify that Class specifications have been met. If time permits, an entry may be returned for correction.
16. Dixon Gallery and Gardens and Botanical Arts Chairs will be responsible for installation of the exhibits. Each exhibit will be handled with the utmost care. Indicate in writing, and include with the exhibit, any special instructions for handling and display.
17. A Statement of Intent (25 words or less) is required and must be submitted with the entry card. A Statement of Intent is a brief written paragraph offering explanation of the exhibit's creation by the exhibitor(s) of the message the exhibit intends to convey.

18. Scale of points by which Classes are to be judged:

	POINTS
Design	35
Craftsmanship	30
Creativity	15
Interpretation of theme	10
Distinction	10
Total	100

All entries must be removed Monday, April 15, 2024 between 9:00 a.m. and 12:00 p.m.

INQUIRIES

Questions regarding Class requirements may be directed to Ainslie Todd or Elizabeth Coors by email at any time.

Botanical Arts Chair:	Ainslie Todd	ainslietodd@bellsouth.net
Co-chair:	Elizabeth Coors	ehcoors@comcast.net

Division IV | Botanical Arts

RESIDENCE, LIVING ROOM AND LIBRARY

Class Consultants: Ainslie Todd ainslietodd@bellsouth.net
Elizabeth Coors ehcoors@comcast.net

Class 1: Mirror, Mirror on the Wall

6 Entries

Embellish a wooden table/vanity mirror with an intricate design. The mirror measuring 6.5" x 9.1" will be displayed in a 40.5" tall museum vitrine with gray linen base, covered with an acrylic bonnet. The vanity mirror will be provided by the committee and will be mailed to the entrant upon registration. Please include a photograph with an entry. Entries will be viewed from three sides. Entry fee: \$35.00

To register, email Elizabeth Coors: ehcoors@comcast.net

Class 2: The Imitation Game

6 Entries

Embellish a cuff bracelet with a design that is inspired by plants, animals or insects found near American waterways. A clear, acrylic resin bracelet with 6 cm inner diameter will be provided by the committee and will be mailed to the entrant upon registration. The bracelet will be displayed in a 40.5" tall museum vitrine with gray linen base, covered with an acrylic bonnet. Please include a photograph with an entry. Entries will be viewed from three sides. Entry fee: \$35.00

To register, email Elizabeth Coors: ehcoors@comcast.net

Class 3: All that Glitters

6 Entries

Create a stunning pendant designed to hang on a 22 mm black satin cord with a length of approximately 16 inches and displayed on a black, velvet jewelry display stand measuring 9" x 7". Jewelry easels will be displayed in a 40.5" tall museum vitrine with gray linen base, covered with an acrylic bonnet. Cord will be provided by the Committee at registration. A simple knot in the cord will suffice as a clasp. Entries will be viewed from three sides. Please provide a photograph with an entry. Entry fee: \$ 30.00

To order, email: Elizabeth Coors: ehcoors@comcast.net

Maintaining the Rhythm: The Beautiful, Life-changing, Sustainable Rain Garden

THE DIXON GARDENS CONSERVATORY

This is an Educational Component Exhibit.

When it rains, water is naturally kept from being absorbed into the ground by numerous manmade, impervious surfaces such as rooftops, patios, driveways, and parking lots. These surfaces make our lives better but, they have replaced the previous natural vegetated landscape. As a result, water runoff is faster and more concentrated.

The establishment of rain gardens is an economical solution that individuals can implement, in order to help our rivers, streams, lakes and water systems. These unobtrusive structures are designed to capture water runoff and to create beautiful gardens that flourish with soils and native plants that are suited to the waters streaming from impervious man made surfaces. The rain garden microsystem attracts more bees, butterflies and birds to pollinate native species, thereby improving the flora and fauna of the area. Additionally, rain gardens reduce the burden on the city, county and state infrastructure as it diverts the water that stresses our vulnerable and outdated drainage systems.

Statement of Intent: The exhibit will demonstrate how to create a rain garden, at home as a way to improve your property while adding beauty. We will walk you through an example of a rain garden and thoughtfully explain details about the importance of rain gardens in your area and the community.

The GCA Flower Show Awards described below are approved and will be presented if merited.

DIVISION I, FLORAL DESIGN

The **Carol Coffey Swift Medal of Excellence** may be awarded to members of GCA clubs. It is offered in recognition of an arrangement of great distinction in a competitive Class at a GCA Major Flower Show. Either an individual or joint entries are eligible. The entry must have placed first, second, or third. An entry in any challenge Class is not eligible to receive this award.

The **Fenwick Medal** may be awarded to members of GCA clubs in competitive floral design Classes at a GCA Major Flower Show. It is offered in recognition of creative work of outstanding beauty using predominantly fresh plant material. The awarding of the Fenwick Medal lies in the clear interpretation by the judges of the intent of the medal. A standard of creativity and quality in a highly competitive show rather than Best in Show is required. The design must have placed first, second, or third. An entry in a challenge Class is not eligible to receive this award.

The **Margaret Clover Symonds Medal** may be awarded to members of GCA clubs in a competitive floral design Class at a GCA Major Flower Show. The design must be an innovative, modern design, creatively combining man-made material(s) with fresh and/ or dried plant material (as the schedule permits). Either individual or joint entries are eligible. The entry must have placed first, second, or third. An entry in a challenge Class is not eligible to receive this award.

The **Sandra Baylor Novice Award** may be given at a GCA and a GCA Major Flower Show to an exhibitor who is a member of a GCA club and who has never won first place or this award in the Floral Design Division of a GCA or a GCA Major Flower Show. In a GCA Major Show a novice is an individual who has not won a first place ribbon in a GCA Major Show or a sanctioned Non-GCA Major Show, or this Floral Design award. It shall be awarded to an individual novice exhibitor for a unique and skillful response to the schedule. Novice entries placing first, second, or third in any competitive Class except challenge Classes are eligible for this award.

DIVISION II, HORTICULTURE

The **Certificate of Excellence in Horticulture** may be awarded at a GCA Major Flower Show to GCA clubs or club members, non-members, or other organizations for an exhibit of great distinction in a competitive horticulture Class. The entry must have placed first, second, or third.

The **Elizabeth Platt Corning Medal** may be awarded only to members of GCA clubs only in a competitive horticulture Class in a GCA Major Flower Show. The medal is to be awarded to an entry presented with distinction and originality notable for its cultural difficulty. It must have achieved an exceptional standard of horticultural excellence. Extra consideration will be given to an entry propagated by the exhibitor; full propagation details must be listed on a card accompanying the entry. The entry must have been grown by the exhibitor for at least six months. The medal may be awarded for a single plant, collection of plants, container garden, or cut specimen(s). Individual, joint, or club entries are eligible. The entry must have placed first, second, or third. The medal may not be awarded more than once to the same exhibit.

The **Louise Agee Wrinkle Horticulture Propagation Award** may be awarded at a GCA Major Flower Show to a GCA member for skill in plant propagation. The exhibit must have been propagated and grown by its exhibitor for at least six months and should be distinguished by its prime condition, cultural perfection, attractive presentation and flawless grooming. It is for rooted plants propagated by seed, cuttings or other traditional methods. It can be a single specimen, source plant and its offspring, or a collection. The dates and methods of propagation must be recorded on an accompanying propagation card. The medal may not be awarded more than once to the same exhibit.

DIVISION III, PHOTOGRAPHY

The **Certificate of Excellence in Photography** may be awarded at a GCA Major Flower Show to GCA clubs or club members, non-members, or other organizations for an exhibit of great distinction in a competitive photography Class. The entry must have placed first, second or third.

The **Photography Creativity Award** may be awarded at a GCA Major Flower Show to an exhibitor who is a member of a GCA club for creative and technical excellence in response to the theme of the schedule. The entry must have placed first, second or third.

DIVISION IV, BOTANICAL ARTS

The **Botanical Arts Creativity Award** may be awarded at a GCA Major Flower Show to a member of a GCA club for excellent craftsmanship and creative response to the theme of the schedule. The entry must have placed first, second, or third.

The **Certificate of Excellence in Botanical Arts** may be awarded at a GCA Major Flower Show to GCA clubs or club members, non-members, or other organizations for an exhibit of great distinction in a competitive Botanical Arts Class. The entry must have placed first, second or third.

DIVISION II, III, IV

The **GCA Novice Award** may be given at a GCA and a GCA Major Flower Show in the Horticulture, Photography and Botanical Arts to an exhibitor who is a member of a GCA club and who has never won first place or a novice award in the division entered, of a GCA or a GCA Major Flower Show. In a GCA Major Show a novice is an individual who has not won a first place ribbon or a GCA Special Award in the division entered in the GCA Major Show or a sanctioned Non-GCA Major Show. It shall be awarded to an individual novice exhibitor for an outstanding exhibit. Novice entries placing first, second, or third are eligible for this award.

OVERALL

Best in Show, selected from among the first-place winners, may be awarded in each division.

Judges' Commendation may be given to an entry, Class, section, special exhibit or other aspect of the show that is of exceptional merit.

Award of Appreciation may be given to thank an exhibitor or group for participation. The award may also be given to non-judged Classes.

DIVISION I, FLORAL DESIGN

Best Use of Color
Most Innovative Line Design

DIVISION II, HORTICULTURE

Canada Trophy

Awarded to a Memphis Garden Club member for the best daffodil

Best Cut Specimen Grown for Flower
Best Cut Specimen Grown for Foliage
Best Container Plant Grown for Flowers
Best Container Plant Grown for Foliage

DIXON MUSEUM AWARD

Curator's Award

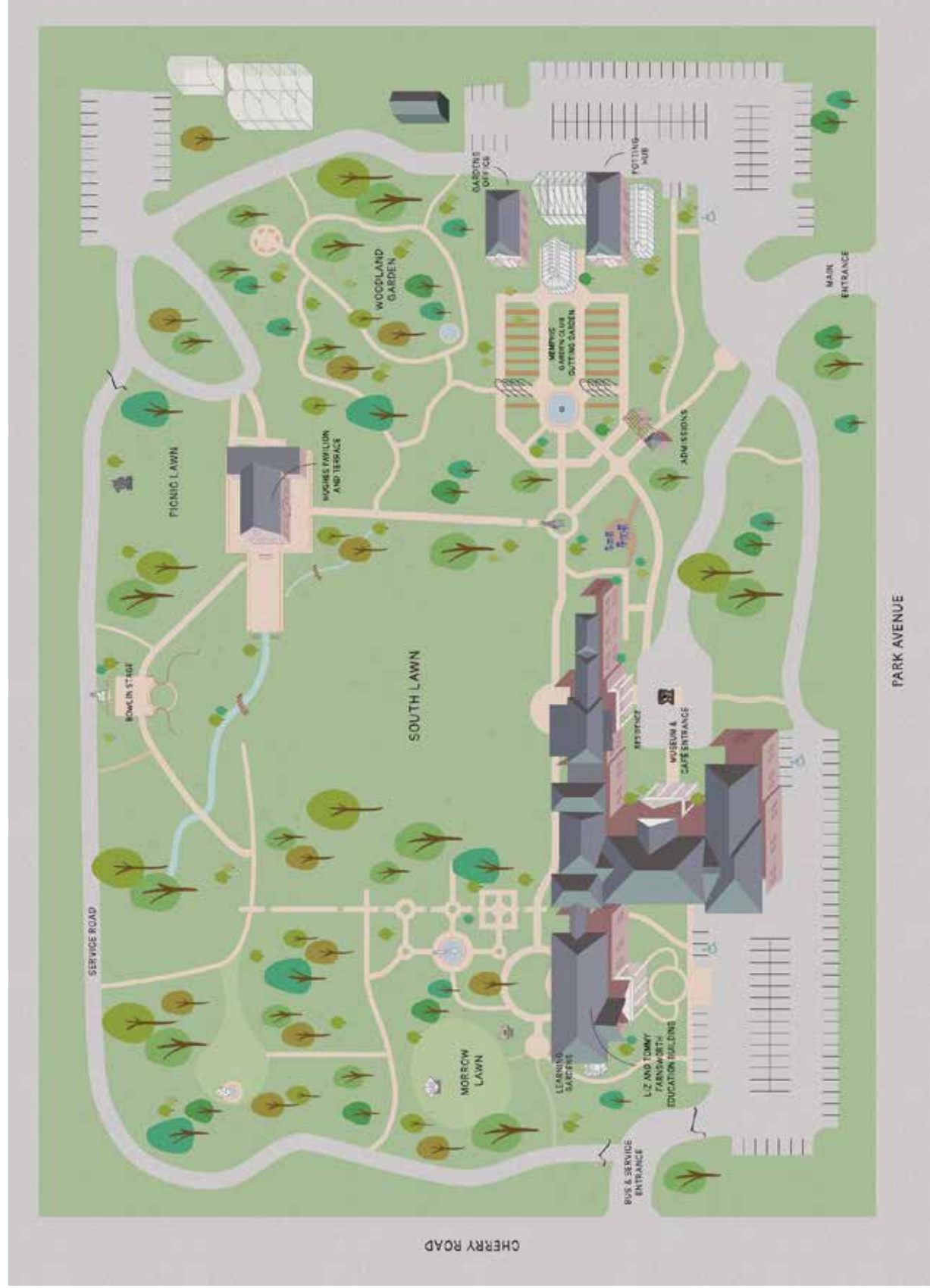

DIXON
GALLERY & GARDENS

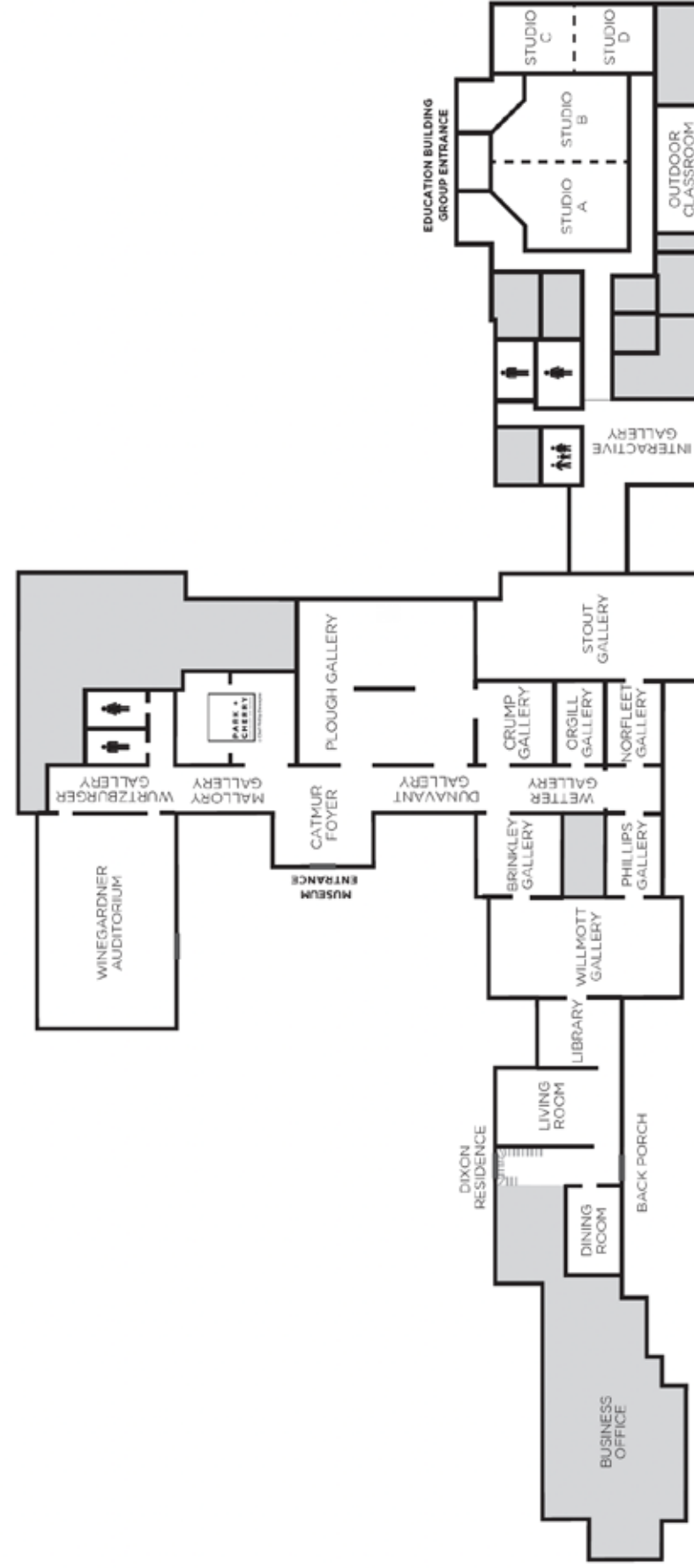

Notes:

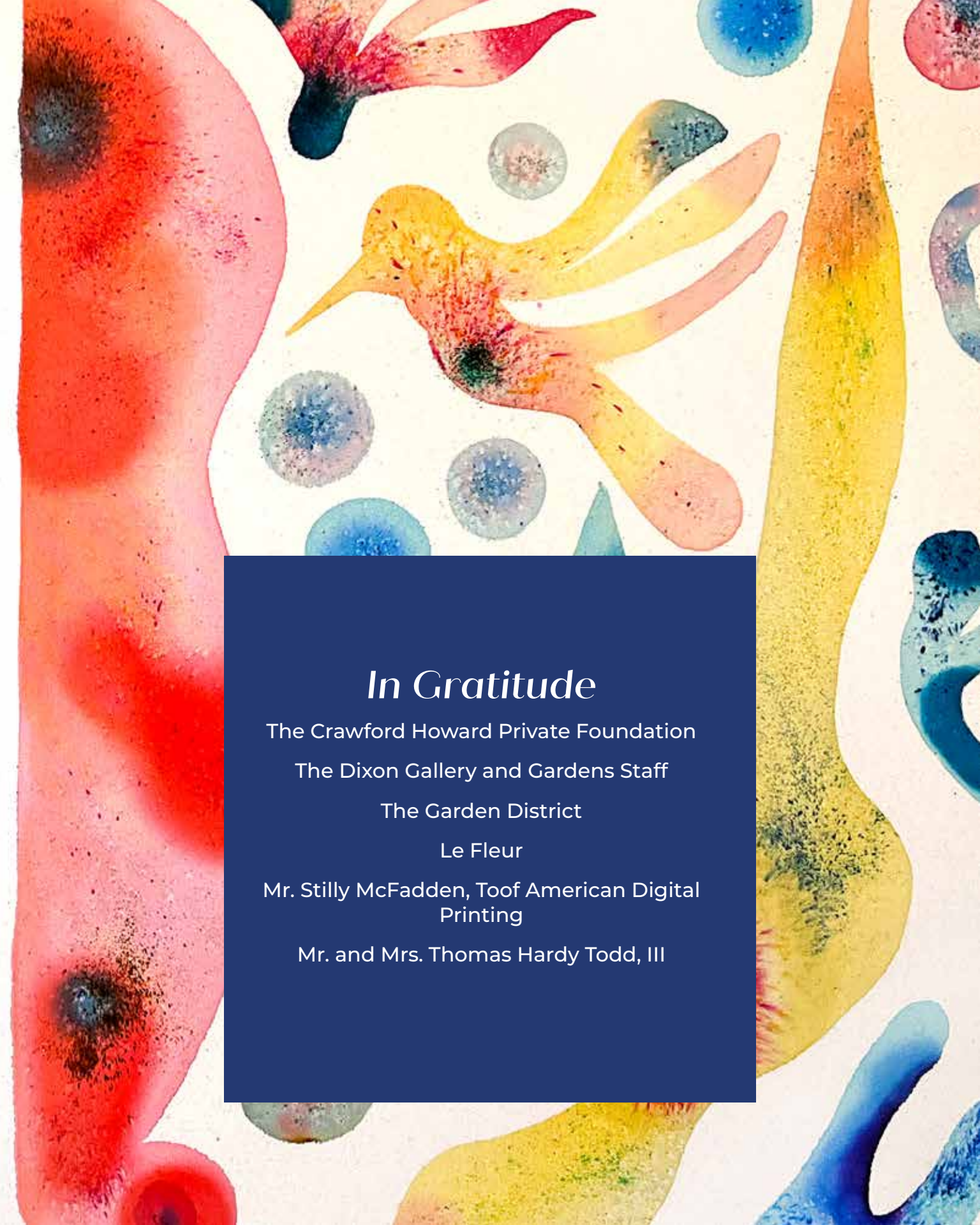

In Gratitude

The Crawford Howard Private Foundation

The Dixon Gallery and Gardens Staff

The Garden District

Le Fleur

Mr. Stilly McFadden, Toof American Digital
Printing

Mr. and Mrs. Thomas Hardy Todd, III

OPPOSITE PAGE: KONG WEE PANG | *Rain*, 2023 | Watercolor | on unprimed canvas | 40 x 50 inches
Courtesy of the artist



COVER ART:

MIKAYLA WASHINGTON

Revive, 2023 | Acrylic on canvas | 72 x 48 inches Courtesy of the artist



MEMPHIS
GARDEN CLUB

www.memphisgardenclub.org | www.dixon.org